

## OPTIONS:

-B

### CONNECTORS WITH SNAP-IN-MOUNTING CLIPS

The mounting clips are designed for use with 1.6mm P.C.B.thickness,the material of mounting clips is copper alloy and it is tin plated.

The connector with a board-lock is pressed onto the PCB and fixed into the mounting hole of the PCB by spring action of the board-lock.

The force of the spring contact is sufficient to hold the connector in place during the solder process.

For drilled through mounting holes,the holding force of the connector is significantly increased by soldering of the board-locks during the process.

All solder connectors can be ordered with this feature,please refer to page 38 for the complete part number coding.

E.G.126-2-486-20-10-B

Type B,C-Male Connectors

Q,R-Female Connectors

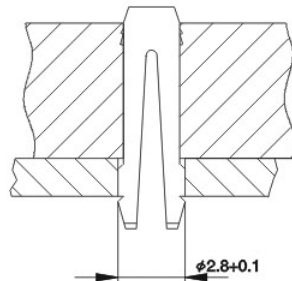

Type B,C-Female Connectors

Q,R-Male Connectors

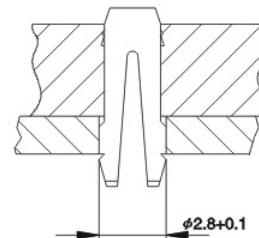

-A

&

-L

### PRE-MATING/LATE-MATING MALE CONTACT PIN FOR TYPE B.C.R.F.H.

Premating contacts can be loaded in any position upon request.

## Dimension

TYPE	Standard	Premating contact	Late mate contact
B,B/2,C,C/2	4.9 $\pm$ 0.1	+1.0=5.9 $\pm$ 0.1	-0.8=4.1 $\pm$ 0.1
Q,1/2Q	4.9 $\pm$ 0.1	+1.0=5.9 $\pm$ 0.1	-0.8=4.1 $\pm$ 0.1
R,R/2 Mating side	4.9 $\pm$ 0.1	+0.8=5.7 $\pm$ 0.1	-0.4=4.5 $\pm$ 0.1
F	6.1 $\pm$ 0.1	+1.5=7.6 $\pm$ 0.1	-
h	6.5 $\pm$ 0.1	+1.5=8.0 $\pm$ 0.1	-

Other length on request

### Thru Hold Specifications for Pressfit Technology,

### Thru Hold Drilling,SN and Bare CU

### PCB Hole Tin Plated

Hole	$\phi 1.0\text{mm}$
Bore hold	1.12~1.15mm
Cu	25~75um
SN	5~15um
Plated-Thru hold	0.94~1.09mm
PCB Thickness	$\geq 1.6\text{mm}$
Press in Force Per Pin	150 N Max
Retention Force Per Pin	50 N Max

Longitudinal Section of P.T.H.

With Twinap Press-Fit Pin

