

## Right Angle Female Type Q Connectors–Inversed 64 Positions

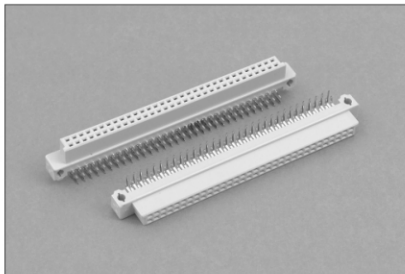

### Option:

- Extended male contact
- Connector with pre-installed snap-in mounting clips.
- Variations
- Please refer to page 46 for complete part number coding
- Other variations, please consult factory

### Dimensions

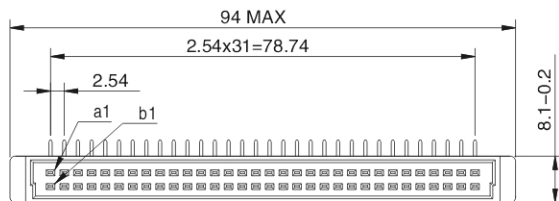

### Recommended P.C.B. layout

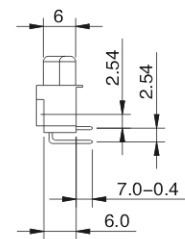
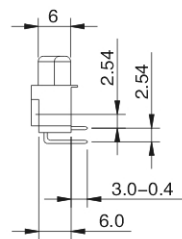
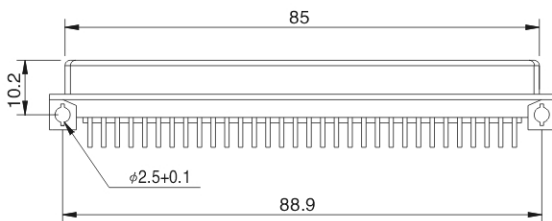
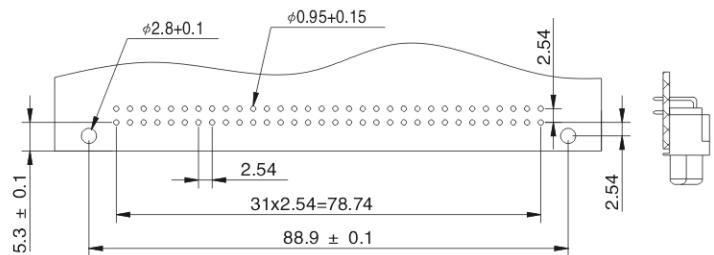

### Ordering Information

NO. OF CONTACTS		64	32	32	16
POSITION		a+b	a	a+b (2.4.6...)	a (2.4.6...)
TERMINATION	QUALITY	Part Number			
3.0 mm	III	130-1-643-20-10	130-1-321-20-10	130-3-323-20-10	130-3-161-20-10
	II	130-1-643-20-20	130-1-321-20-20	130-3-323-20-20	130-3-161-20-20
7.0 mm	III	130-1-643-17-10	130-1-321-17-10	130-3-323-17-10	130-3-161-17-10
	II	130-1-643-17-20	130-1-321-17-20	130-3-323-17-20	130-3-161-17-20

Dimensions shown are for reference purpose only, All dimensions are in millimeters unless otherwise specified.