

## Right Angle Male Type Half C Connectors 48 Positions

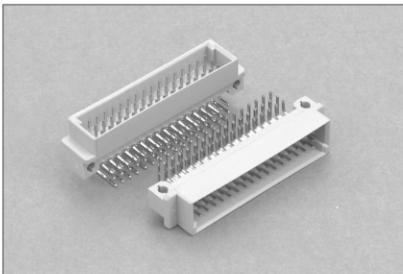

### Option:

- Connector with pre-installed snap-in mounting clips.
- Other Variations
- Please refer to page 46 for complete part number coding
- Other variations, please consult factory

### Dimensions

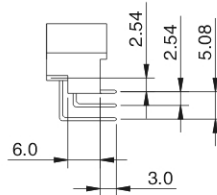
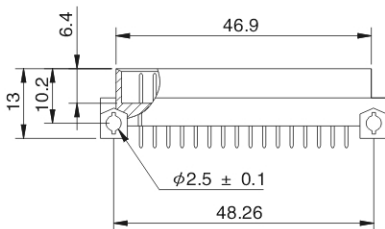
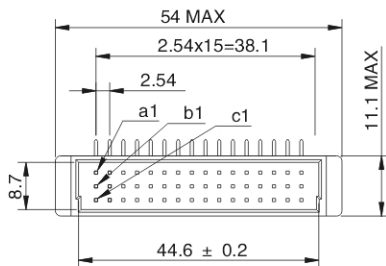

### Recommended P.C.B. layout

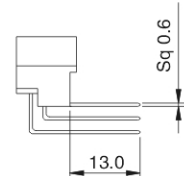
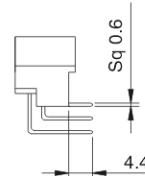
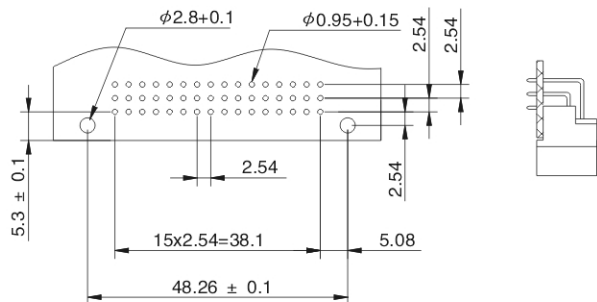

### Ordering Information

NO. OF CONTACTS		48	32	32	16	24	16
POSITION		a+b+c	a+c	a+b	a	a+b+c(2.4.6...)	a+c(2.4.6...)
TERMINATION	QUALITY	PART NUMBER					
3.0 mm	III	126-2-486-20-10	126-2-324-20-10	126-2-323-20-10	126-2-161-20-10	126-4-246-20-10	126-4-164-20-10
	II	126-2-486-20-20	126-2-324-20-20	126-2-323-20-20	126-2-161-20-20	126-4-246-20-20	126-4-164-20-20
4.4 mm	III	126-2-486-21-10	126-2-324-21-10	126-2-323-21-10	126-2-161-21-10	126-4-246-21-10	126-4-164-21-10
	II	126-2-486-21-20	126-2-324-21-20	126-2-323-21-20	126-2-161-21-20	126-4-246-21-20	126-4-164-21-20
13.0 mm	III	126-2-486-22-10	126-2-324-22-10	126-2-323-22-10	126-2-161-22-10	126-4-246-22-10	126-4-164-22-10
	II	126-2-486-22-20	126-2-324-22-20	126-2-323-22-20	126-2-161-22-20	126-4-246-22-20	126-4-164-22-20

P.S.1/3C is available, please consult with factory

Dimensions shown are for reference purpose only, All dimensions are in millimeters unless otherwise specified.