

Right Angle Male Type Half B Connectors 32 Positions

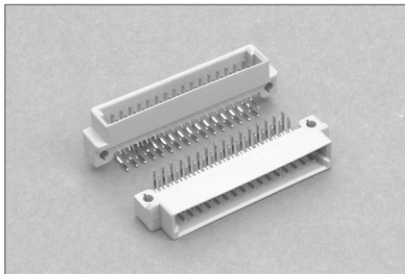

Option:

- Extended male contact
- Connector with pre-installed snap-in mounting clips.
- Variations
- Please refer to page 46 for complete part number coding
- Other variations, please consult factory

Dimensions

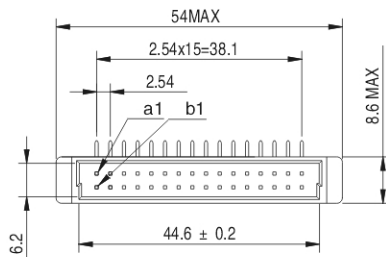

Recommended P.C.B. layout

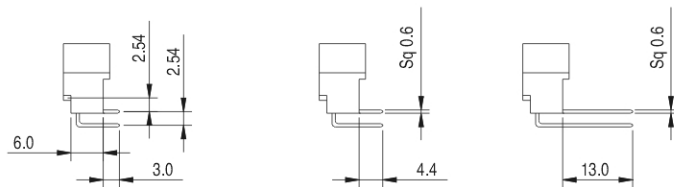
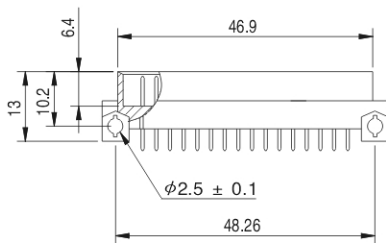
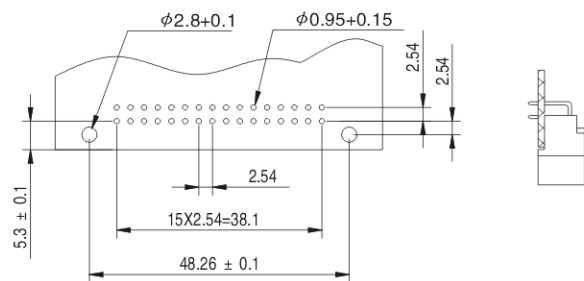

Ordering Information

NO. OF CONTACTS		32	16	16
POSITION		a+b	a	a+b(2,4,6 ...)
TERMINATION	QUALITY	PART NUMBER		
3.0 mm	III	125-2-323-20-10	125-2-161-20-10	125-4-163-20-10
	II	125-2-323-20-20	125-2-161-20-20	125-4-163-20-20
4.4 mm	III	125-2-323-21-10	125-2-161-21-10	125-4-163-21-10
	II	125-2-323-21-20	125-2-161-21-20	125-4-163-21-20
13.0 mm	III	125-2-323-22-10	125-2-161-22-10	125-4-163-22-10
	II	125-2-323-22-20	125-2-161-22-20	125-4-163-22-20

P.S.1/3R is available, please consult with factory

Dimensions shown are for reference purpose only, All dimensions are in millimeters unless otherwise specified.