

# .098" (2.50mm) Center Crimp Terminal Housing

## 7000 Series

### FEATURES:

- . 2-20 Circuits
- . Friction lock
- . Nylon, [UL 94V-0]
- . Accepts double cantilever crimp terminal [7000-T]
- . Mates with 7600 series wafers polarized

### SPECIFICATIONS:

- . Current rating: 3A AC, DC
- . Voltage rating: 250V AC, Maximum
- . Temperature range: -40°C ~ +105°C
- . Contact resistance: Initial Value/10mΩ max.  
After environmental testing  
/20mΩ max.
- . Insulation resistance: 5000 MΩ min
- . Withstand voltage: 1500V AC/minute
- . Applicable wires: #30 ~ #22

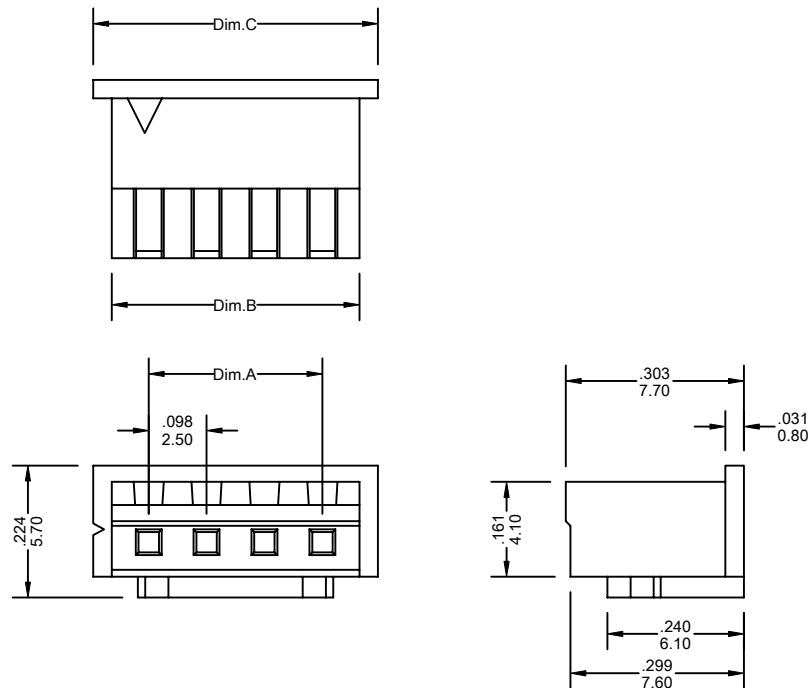

### Ordering Information 7000 Series

Series No.	No. of Contacts	
7000	- 04P	- A
7000 Series	02P ~ 20P	RoHs

### Dimensional Information

Circuits	Dim.A± .008 0.20	Dim.B± .008 0.20	Dim.B± .008 0.20	Circuits	Dim.A± .008 0.20	Dim.B± .008 0.20	Dim.B± .008 0.20
2	.098 2.50	.224 5.70	.287 7.30	3	.197 5.00	.323 8.20	.386 9.80
7000 Series * FOR CIRCUIT SIZES 4 THROUGH 20 ADD .098" OR 2.50MM FOR EACH ADDITIONAL PIN.							