

.200" (5.08mm) Center Wafer Assembly



4508 Series

FEATURES:

- . 2-20 Circuits
- . .045" [1.14mm] Squire wire pins
- . Nylon, [UL 94V-2] or [UL 94V-0]
- . Straight or Right angle pins
- . Mate with Center Crimp connector VEN 5080

SPECIFICATIONS:

- . Current rating: 7A AC, DC
- . Voltage rating: 250V AC, Maximum
- . Temperature range: -40°C ~+ 105°C
- . Contact resistance: Initial Value/10mΩ max.
After environmental testing /20mΩ max.
- . Insulation resistance: 5000 MΩ min
- . Withstand Voltage: 1500V AC/minute
- . Applicable PC board thickness: .063"[1.6mm]

UNIT: INCH
MM

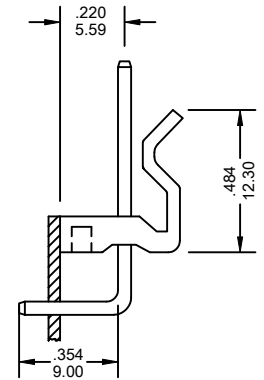
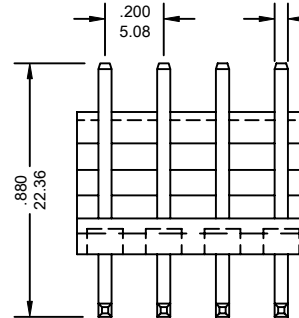
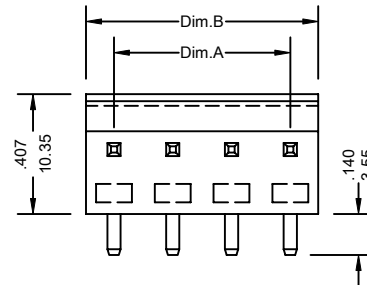

(R: Right Angle) [A]

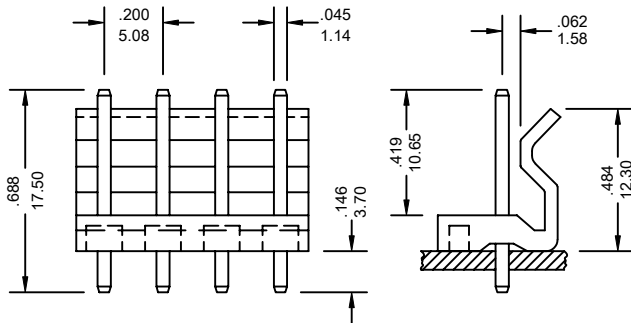
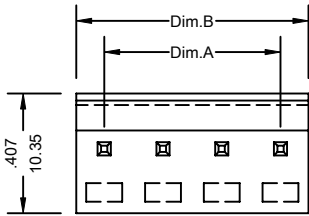

(S: Straight)

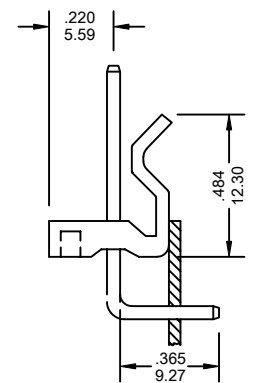
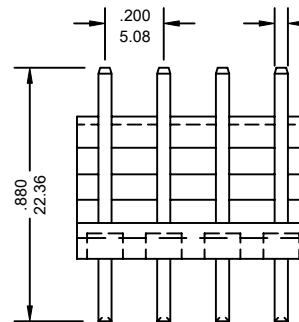
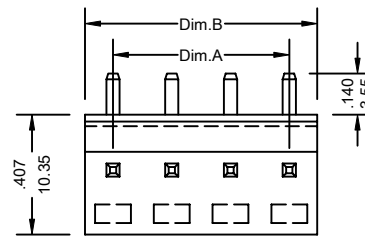

(R1: Right Angle) [B]

Ordering Information 4508 Series

Series No.	No. of Contacts	Contact Type	Contact Plating	Material	
4508	04P	S	G1	V0	PB
4508 Series	02P ~ 20P	S: Straight R: Right Angle [A] R1: Right Angle [B]	T: Tin G1: Gold Flash G5: 5u" Gold G10: 10u" Gold G15: 15u" Gold G30: 30u" Gold [G: Full Gold]	V0: UL 94V-0, Nylon V2: UL 94V-2, Nylon	RoHs
* PIN LENGTH CAN BE CHANGED TO CUSTOM'S SPECIFICATION					

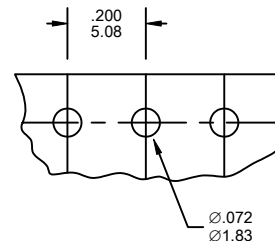

Recommended P.C Board Hole Dimensions

Dimensional Information

Circuits	Dim.A± .008 0.20	Dim.B± .008 0.20	Circuits	Dim.A± .008 0.20	Dim.B± .008 0.20	Circuits	Dim.A± .008 0.20	Dim.B± .008 0.20
2	.200 5.08	.390 9.91	3	.400 10.16	.590 14.99	4	.600 15.24	.790 20.07

4508 Series

* FOR CIRCUIT SIZES 5 THROUGH 20 ADD .200" OR 5.08MM FOR EACH ADDITIONAL PIN.