

# .100" (2.54mm) Pitch DIN 41612 Connector

25043 Series  
Male, Style C solder type

**FEATURES:**

- . 96 Circuits
- . Housing: PBT+30% Glass Filled UL 94V-0
- . Contact: Brass, Press Fit Phosphor Bronze
- . Contact Plating: Gold Plating

**SPECIFICATIONS:**

- . Current rating: 2A
- . Temperatur range: -55°C ~+ 125°C
- . Contact resistance: 20mΩ max.
- . Mating Force: .93N max. per pin
- . Solder tails for 1.6mm (.062")
- PCB savailable

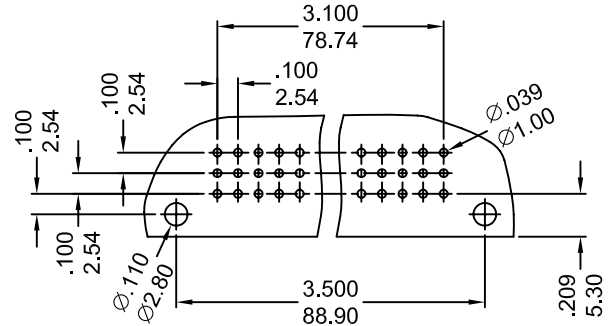

UNIT: INCH  
MM

Recommended P.C Board  
Hole Layout

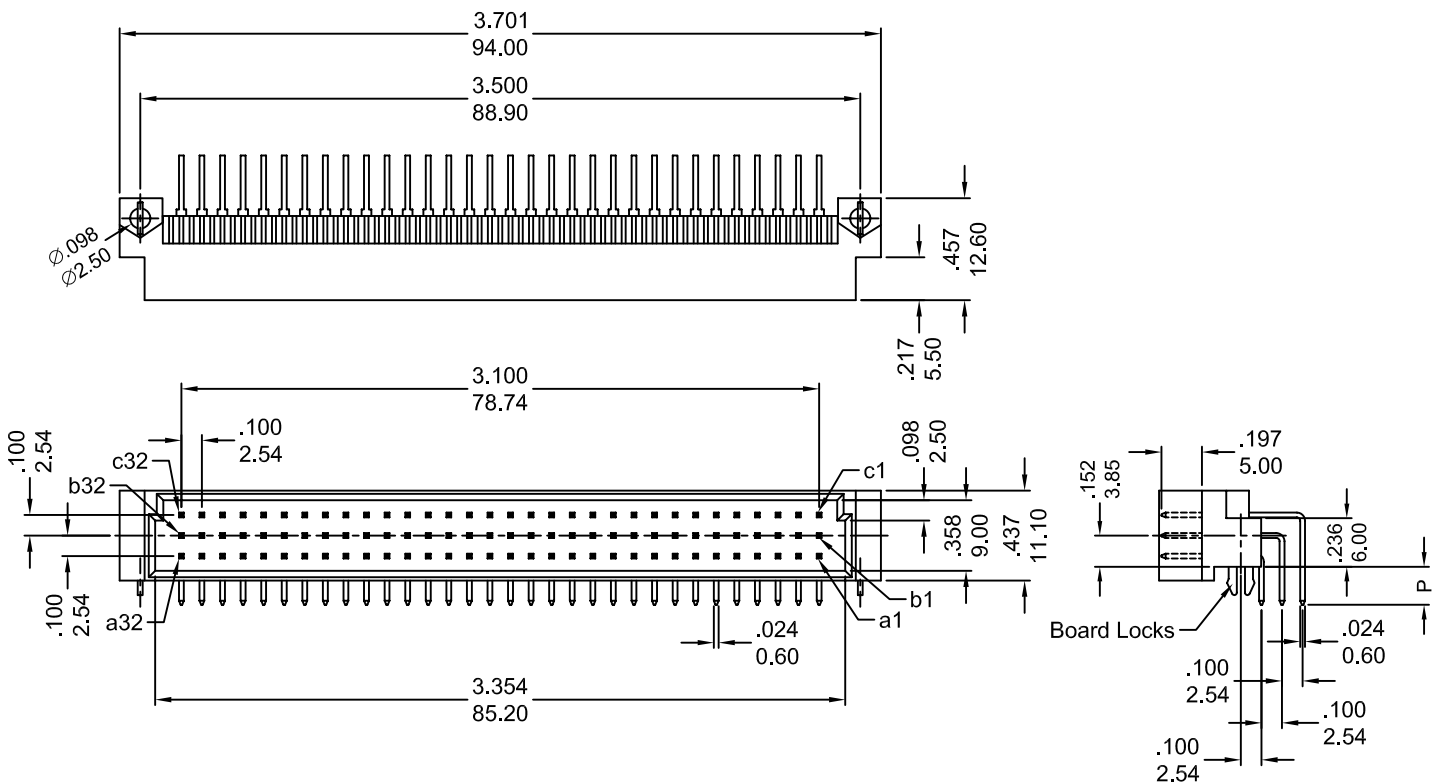

**Ordering Information 25043 Series Solder**

Series No.	Circuits	Contact Loading Rows	Solder Tail Dimension P	Board Locks	Machine Test Conditions	
25043	- 96M	2	1	2	3	- PB
25043 Series	96M	0:Full a 1:Full a,c 2:Full a,b,c	1:2.80	1:Yes 2:No	2:>400 3:>50	RoHs