

.079"X.079" (2.00mmX2.00mm) Center Dual Row Crimp Terminal Housing

2020 Series

FEATURES:

- . 10-34 Circuits
- . NYLON 66, [UL 94V-0]
- . Accepts double cantilever crimp terminal [2020-T]
- . Mates with .0197"[0.50mm]
- . Mates with 2060 wafer

SPECIFICATIONS:

- . Current rating: 2A AC, DC
- . Voltage rating: 250V AC, Maximum
- . Temperature range: -40°C ~+ 105°C
- . Contact resistance: Initial Value/10mΩ max.
After environmental testing /20mΩ max.
- . Insulation resistance: 5000 MΩ min
- . Withstand Voltage: 1500V AC/minute

UNIT: INCH
MM

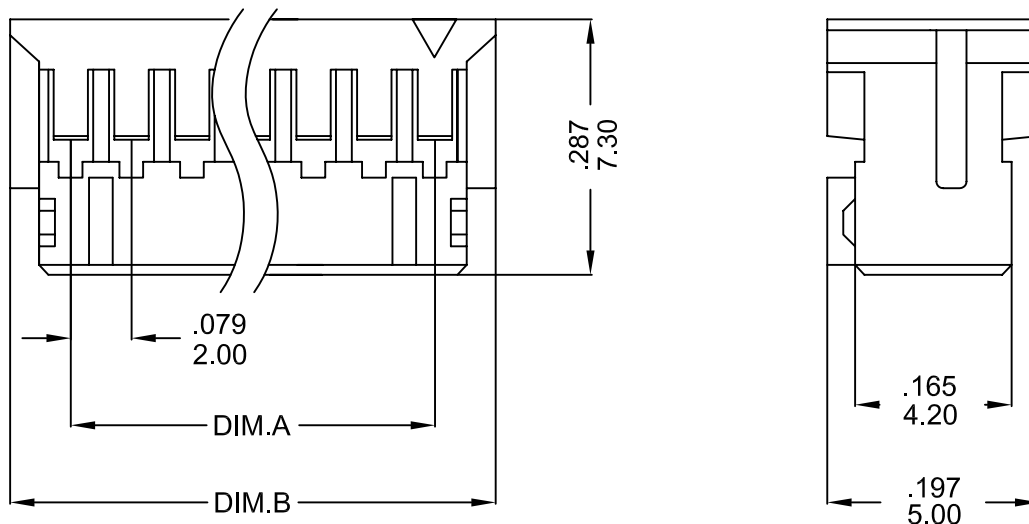

Ordering Information 2020 Series

Series No.	No. Of Contacts	
2020	- 2X05P	- A
2020 Series	2X05P ~ 2X17P	RoHs

Dimensional Information

Circuits	10	12	14	16	18	20	22	24	26	28	30	32	34	
Dim.A±	.008 0.20	.315 8.00	.400 10.0	.472 12.0	.551 14.0	.630 16.0	.709 18.0	.787 20.0	.866 22.0	.945 24.0	1.02 26.0	1.10 28.0	1.18 30.0	1.26 32.0
Dim.B±	.008 0.20	.470 11.9	.547 13.9	.626 15.9	.704 17.9	.780 19.9	.862 21.9	.941 23.9	1.02 25.9	1.10 27.9	1.18 29.9	1.26 31.9	1.33 33.9	1.41 35.9