

.100" (2.54mm) Center P.C.Board Connectors

1254-B Series Bottom Entry

FEATURES:

- . 2-25 Circuits
- . Housing, UL 94V-0 Nylon 66
- . Designed for parallel and perpendicular board stacking, connection
- . Mates with .025"[0.64mm] square pins
- . Mounted on a board right angle headers, and straight headers

SPECIFICATIONS:

- . Current rating: 3A AC, DC
- . Voltage rating: 250V AC, Maximum
- . Temperature range: -40°C ~ +105°C
- . Contact resistance: Initial Value/10mΩ max.
After environmental testing /20mΩ max.
- . Insulation resistance: 5000 MΩ min
- . Withstand voltage: 1500V AC/minute
- . Applicable PC board thickness: .063"[1.6mm]

UNIT: INCH
MM

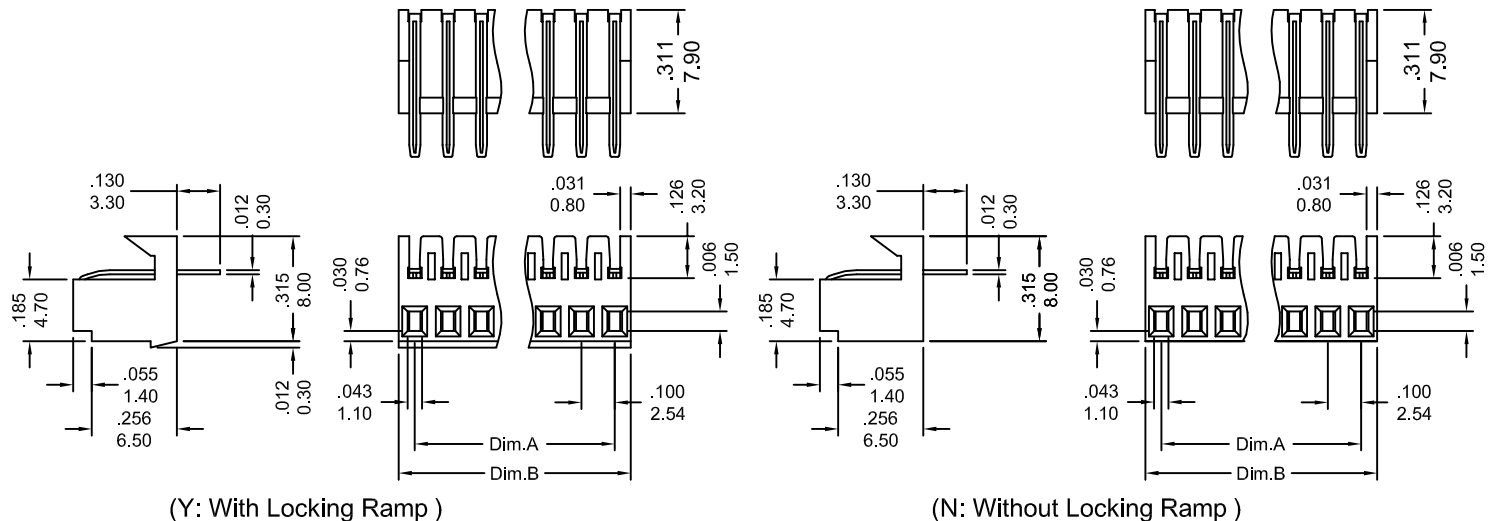

Ordering Information 1254-B Series

| Series No. | No. of Contacts | Polarizing Rib | Contact Plating | |
|---------------|-----------------|---|---|------|
| 1254-B | 07P | Y | T | - PB |
| 1254-B Series | 02P ~ 25P | Y: With Locking Ramp N: Without Locking Ramp | T: Tin S1: Gold Flash S5: 5u" Gold S10: 10u" Gold S15: 15u" Gold S30: 30u" Gold [S: Selective Gold] | RoHs |

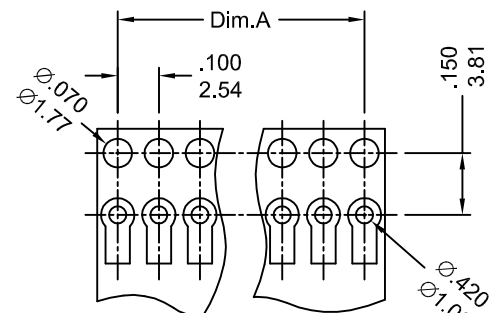

Dimensional Information

P.C.Board Hole Dimensions

| Circuits | Dim.A± .008 0.20 | Dim.B± .008 0.20 | Circuits | Dim.A± .008 0.20 | Dim.B± .008 0.20 | Circuits | Dim.A± .008 0.20 | Dim.B± .008 0.20 | Circuits | Dim.A± .008 0.20 | Dim.B± .008 0.20 |
|----------|---------------------|---------------------|----------|---------------------|---------------------|----------|---------------------|---------------------|----------|---------------------|---------------------|
| 2 | .100 2.54 | .200 5.08 | 3 | .200 5.08 | .300 7.62 | 4 | .300 7.62 | .400 10.16 | 5 | .400 10.16 | .500 12.70 |
| 6 | .500 12.70 | .600 15.24 | 7 | .600 15.24 | .700 17.78 | 8 | .700 17.78 | .800 20.32 | 9 | .800 20.32 | .900 22.86 |
| 10 | .900 22.86 | 1.000 25.40 | 11 | 1.000 25.40 | 1.100 27.94 | 12 | 1.100 27.94 | 1.200 30.48 | 13 | 1.200 30.48 | 1.300 33.02 |
| 14 | 1.300 33.02 | 1.400 35.56 | 15 | 1.400 35.56 | 1.500 38.10 | 16 | 1.500 38.10 | 1.600 40.64 | 17 | 1.600 40.64 | 1.700 43.18 |
| 18 | 1.700 43.18 | 1.800 45.72 | 19 | 1.800 45.72 | 1.900 48.26 | 20 | 1.900 48.26 | 2.000 50.80 | 21 | 2.000 50.80 | 2.100 53.34 |
| 22 | 2.100 53.34 | 2.200 55.88 | 23 | 2.200 55.88 | 2.300 58.42 | 24 | 2.300 58.42 | 2.400 60.96 | 25 | 2.400 60.96 | 2.500 63.50 |