

RoHS Compliant

Customer Drawing

| No. | A | B | C |
|-----|-------|-------|-------|
| 04 | 3.75 | 6.40 | 8.50 |
| 05 | 5.00 | 7.65 | 9.75 |
| 06 | 6.25 | 8.90 | 11.00 |
| 07 | 7.50 | 10.15 | 12.25 |
| 08 | 8.75 | 11.40 | 13.50 |
| 09 | 10.00 | 12.65 | 14.75 |
| 10 | 11.25 | 13.90 | 16.00 |
| 11 | 12.50 | 15.15 | 17.25 |
| 12 | 13.75 | 16.40 | 18.50 |
| 13 | 15.00 | 17.65 | 19.75 |
| 14 | 16.25 | 18.90 | 21.00 |
| 15 | 17.50 | 20.15 | 22.25 |
| 16 | 18.75 | 21.40 | 23.50 |
| 17 | 20.00 | 22.65 | 24.75 |
| 18 | 21.25 | 23.90 | 26.00 |
| 19 | 22.50 | 25.15 | 27.25 |
| 20 | 23.75 | 26.40 | 28.50 |
| 21 | 25.00 | 27.65 | 29.75 |
| 22 | 26.25 | 28.90 | 31.00 |
| 23 | 27.50 | 30.15 | 32.25 |
| 24 | 28.75 | 31.40 | 33.50 |
| 25 | 30.00 | 32.65 | 34.75 |
| 26 | 31.25 | 33.90 | 36.00 |
| 27 | 32.50 | 35.15 | 37.25 |
| 28 | 33.75 | 36.40 | 38.50 |
| 29 | 35.00 | 37.65 | 39.75 |
| 30 | 36.25 | 38.90 | 41.00 |
| 31 | 37.50 | 40.15 | 42.25 |
| 32 | 38.75 | 41.40 | 43.50 |
| 33 | 40.00 | 42.65 | 44.75 |
| 34 | 41.25 | 43.90 | 46.00 |
| 35 | 42.50 | 45.15 | 47.25 |
| 36 | 43.75 | 46.40 | 48.50 |
| 37 | 45.00 | 47.65 | 49.75 |
| 38 | 46.25 | 48.90 | 51.00 |
| 39 | 47.50 | 50.15 | 52.25 |
| 40 | 48.75 | 51.40 | 53.50 |

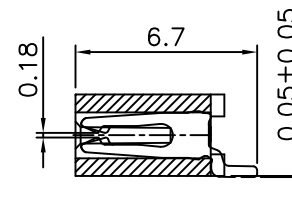
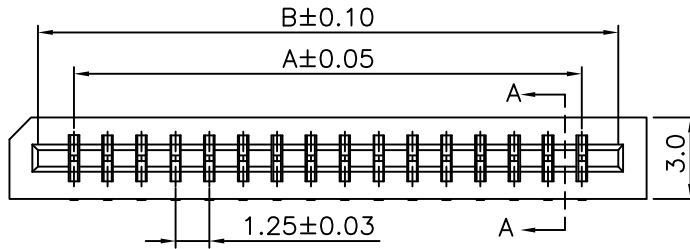

See:A-A

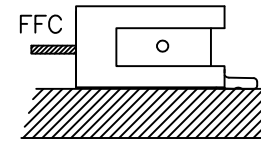
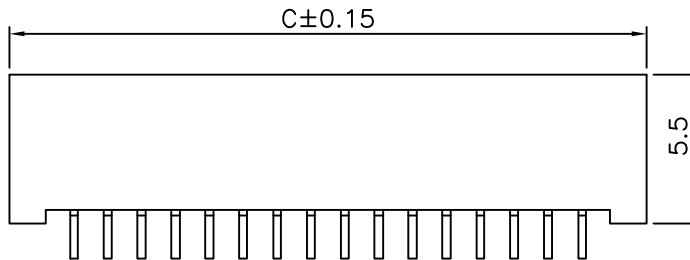

Specifications:

Current Rating:0.5Amp AC/DC
 Voltage Rating:200V AC/DC
 Contact resistance:20m Ohm Max
 Insulator resistance:800M ohm min.
 Withstanding Voltage:500V AC/Minute
 Operating Temperature Range:-25°C~+85°C
 Max Processing Temperature:250°C(30~40Sec.)
 Material And Finish
 Insulator:PPS UL94V-0
 Contact:Phosphor Bronze
 Contact Plated:Full Tin plated,
 Over Nickel 30~40u" Plating All.

How To Order

TFP-C7XXNH-DT1-0CX

Packing
 A:In Tube
 H:In Tray
 No. of Positions

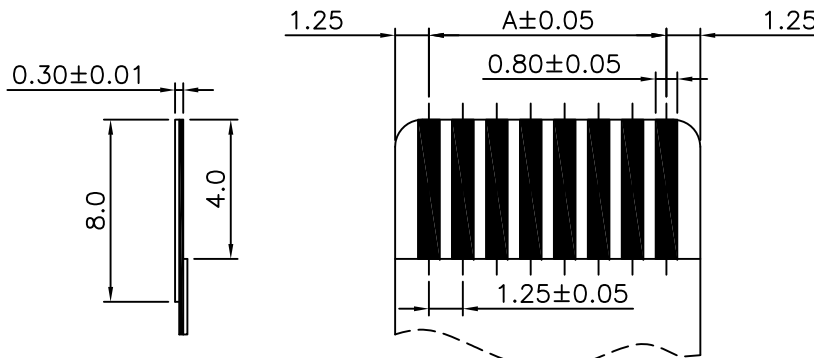

Proper Cable

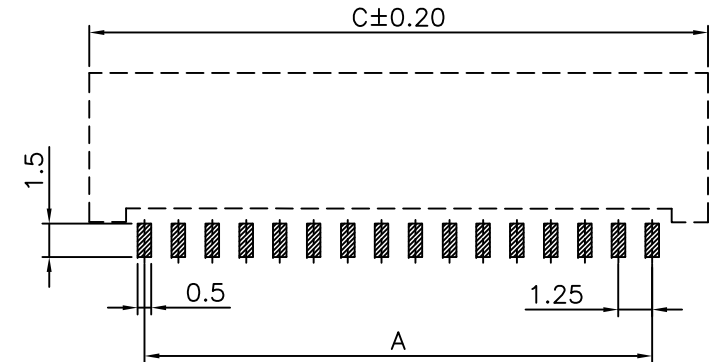

Recommended PCB Layout

| | | | |
|------|--------------|--------------|-------------|
| 1.3 | | | |
| 1.2 | | | |
| 1.1 | Modify Spec. | Wei feng | 29-Mar-2011 |
| 1.0 | RELEASED | HuangBingqiu | 22-Dec-2009 |
| REV. | ECN. NO. | DR.BY | DATE |

崧嵐企業有限公司
 TOWNES ENTERPRISE CO.,LTD

| | |
|-------------|-------------|
| XX.: ±0.25 | XXX.: ±0.40 |
| X.: ±0.20 | X.XXX:±0.05 |
| X.X: ±0.15 | X': ±2° |
| X.XX: ±0.08 | X.X': ±1° |
| UNIT: mm | |
| SCALE: 1:1 | SHEET: 1/1 |

TITLE : 1.25mm Pitch FPC
 Non Zif A Type SMT Dual Contact

A4

| | |
|------------------|-----------------------------|
| APPD.: Alan Chao | PART NO :TFP-C7XXNH-DT1-0CX |
| CHKD.:Cel Wang | DWG. NO.:RDA091222-006(JD) |
| DR.:HuangBingqiu | REV.:1.1 |
| | DATE:22-Dec-2009 |