

Overseas Service And Sales Points

Malaysia
Thailand
Israel
Vietnam
India
Russia
Brazil

Kuala Lumpur
Bangkok
Tel Aviv
Ho Chi Minh
Ahmedabad
Moscow
St. Paul

Philippines
Lebanon
Turkey
Egypt
Chile
Iran
Republic of South Africa

Manila
Beirut
Istanbul
Cairo
Santiago
Teheran



TECORP-GROUP
TECORP Electronics Co., Ltd
3F-3, No.12, Lane 609, Sec. 5, Chung Hsin Rd.
San Chung Dist., New Taipei City, Taiwan
TEL: +886-2-28991146
FAX: +886-2-28992691
<http://www.tecorp-group.com.tw>

Sales&Service Address:

Due to ongoing product modification/improvement, data subject to change without notice.



TECORP-GROUP
AC MOTOR DRIVE

A1000, B1000 Series
AC Motor Drive



TECORP TECHNOLOGY

www.tecorp-group.com.tw

TECORP

TECORP Electronics Co., Ltd. is located in Taipei which is the center of Finance, Trading and Economy in Taiwan, where integrates most high-tech companies. TECORP is dedicated to R&D, manufacturing and selling. Now TECORP has two own trademarks: "HC1" and "HC2"

Since we launched our AC motor drive, TECORP continues making efforts in developing for innovation, raising quality and performance and expanding application range of the products, to provide more suitable products, service and comprehensive solutions for customers.

The series A1000 and B1000 integrate with advanced technology to meet requirements of automation industry. It is extensively used to various applications such machines as CNC, printing, packing, medical, textile, food, plastic, oil, mining, wind force and hydraulic pump, etc. The products are selling in domestic market as well as in South East Asia, Russia and Middle East regions.

TECORP insists on "Integrity" and "combine technology with customers" to run the business, becoming one of the leaders in automation field.

Performance:

1. 32 bit CPU with vector control
2. Control frequency up to 600Hz
3. Speed control accuracy:
Maximum speed $\pm 0.5\%$
4. 1.Dual designation (P: pump & fan
G: heavy loading)

Diversification

1. Built-in PID function
2. Built-in simple PLC function
3. Built-in Brake unit
(15KW or under)
4. 3 types of PWM mode



Accommodation

1. 50°C of temperature
2. Widen input voltage: 220V/400V $\pm 15\%$
3. Protective coating circuit board
4. Anti-disturbance

Modularization

1. Hot pluggable panel
2. Movable control board
3. Attachable fan
(15KW or under)

TECORP TECHNOLOGY

High Performance Vector Control

- It is the best choice in a purpose of high performance including position and speed control like the printing System.
- The highest start torque is able up to 150% in Vector control mode under lowest RPM, to perform perfect stability in speed control.

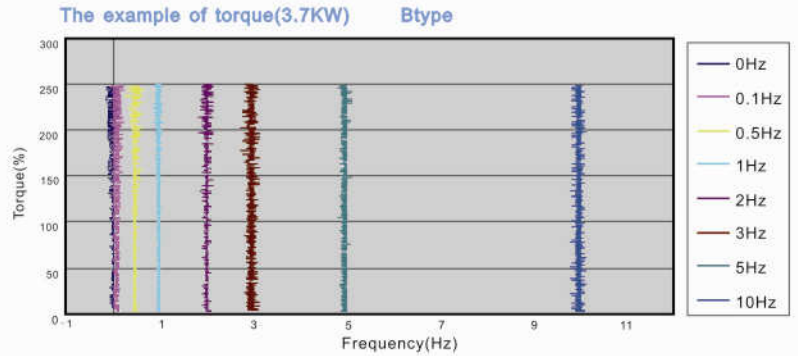
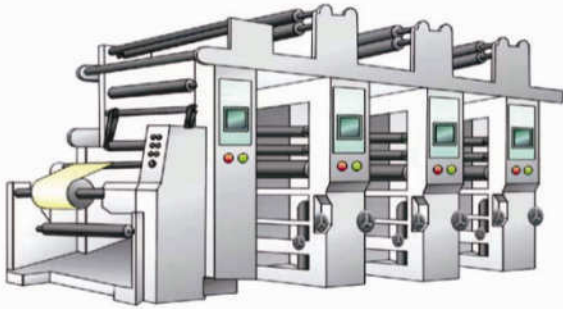

Improve Response to Loading Shock

- When definite vibration occurs in loading, the controller will respond the best torque. It will restrain a motor speed from vibrating by the way of vector control.



Punching machines

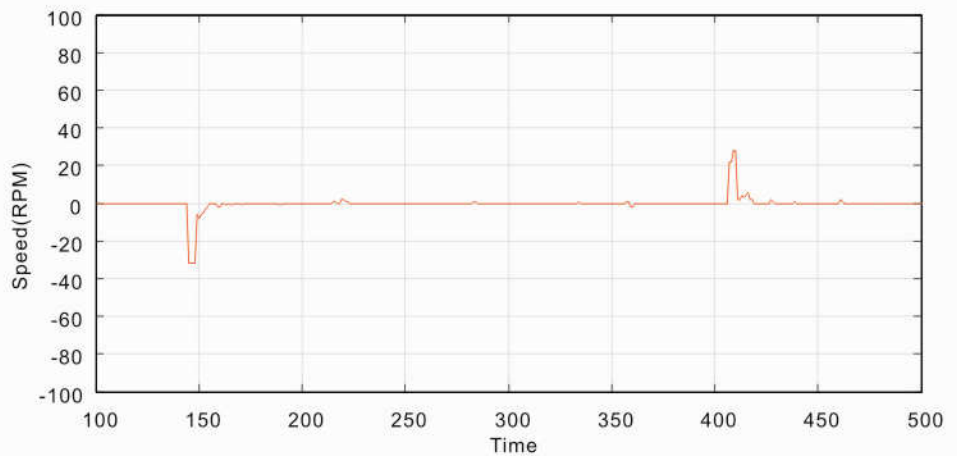

Innovative PID Control Technology

- Enhance stability and response of PID

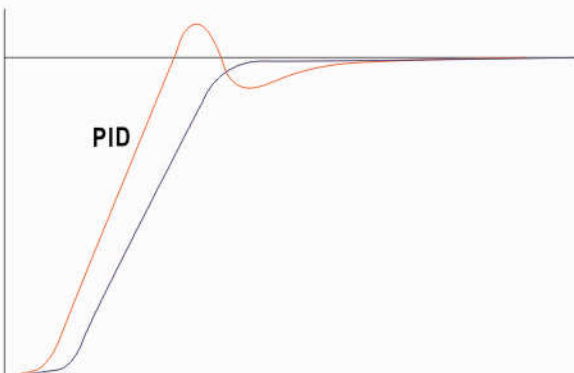

Items		A1000
Input	Rated Voltage Frequency	Single / Three-phase AC220V / 47-63Hz Three-phase AC400V / 47-63Hz
	Voltage Allowable Range	220V / 400V $\pm 15\%$
Output	Output Voltage Range	0-rated input voltage
	Output Frequency Range	0~600Hz
Technical	Control Mode	V/F control
	Overload Capacity	G:150% rated current in 60s P:120% rated current in 60s
	Start Torque	1Hz/150%
	Adjustment Ratio	1: 100
	Speed Control Accuracy	$\pm 1\%$ at maximum speed
	Carrier Frequency	0.5K-15.0KHz
Terminal	Programming Digital Input	4 terminals
	Programming Analog Input	FIV: 0-10V input, FIC: 0-10V or 0-20mA input
	Coupling / Relay Output	1 set
	Analog Output	1 set, option of 0 or 4-20 mA / 0 -10V
Function	Frequency Setting	Digital, Analog, Series communication, Multi-speed, PID
	PID Function	Built in
	Multi-speed Frequency	8 speeds
	Adjustable Frequency	Stable frequency
	Off Power	Continue running in power off instantly
	Jog Key Function	User definition
	Voltage Adjustment	Auto maintain the output voltage stable
	Failure Protection	25 types of failure protection: over current, over voltage, low voltage, over heat, short phase, over load, etc.

Items		B1000
Input	Rated Voltage Frequency	Single / Three-phase AC220V / 47-63Hz Three-phase AC400V / 47-63Hz
	Voltage Allowable Range	220V / 400V $\pm 15\%$
Output	Output Voltage Range	0-rated input voltage
	Output Frequency Range	0~600Hz
Technical	Control Mode	Sensorless vector control, V/F control
	Overload Capacity	150% rated current in 60s
	Start Torque	Sensorless vector control : 0.5Hz / 150%
	Adjustment Ratio	1: 100
	Speed Control Accuracy	$\pm 0.5\%$ at maximum speed
	Carrier Frequency	0.5K-15.0KHz
Terminal	Programming Digital Input	4 terminals
	Programming Analog Input	FIV: 0-10V input, FIC: 0-10V or 0-20mA input
	Coupling / Relay Output	1 set
	Analog Output	1 set, option of 0 or 4-20 mA / 0 -10V
Function	Frequency Setting	Digital, Analog, Series communication, Multi-speed, PID
	PID Function	Built in
	Multi-speed Frequency	8 speeds
	Adjustable Frequency	Stable frequency
	Off Power	Continue running in power off instantly
	Jog Key Function	User definition
	Voltage Adjustment	Auto maintain the output voltage stable
	Failure Protection	25 types of failure protection: over current, over voltage, low voltage, over heat, short phase, over load, etc.

Model Description:

HC2 A

A: for domestic F: for overseas

G: For General-purpose P: For HVAC

Voltage class: 24 AC:200-240V
48 AC:400-460V

Series: A1000 and B1000

Capacity: 00D4: 0.4KW
0D75: 0.75KW

TECORP HC2 series

Model	Input Voltage	Rated Output Capacity (A)	Rated Input Current (A)	Rated Output Current (A)	Suitable Motor (KW)
HC20D75A24-G <input type="checkbox"/> HC201D5A24-P <input type="checkbox"/>	1/3 Phase 220V±15%	0.75/1.5	8.2/14.2	4.5/7	0.75/1.5
HC201D5A24-G <input type="checkbox"/> HC202D2A24-P <input type="checkbox"/>	1/3 Phase 220V±15%	1.5/2.2	14.2/18.4	0.7/10	1.5/2.2
HC202D2A24-G <input type="checkbox"/> HC204D0A24-P <input type="checkbox"/>	3 Phase 220V±15%	2.2/4.0	18.4/21	10/16	2.2/4.0
HC204D0A24-G <input type="checkbox"/> HC205D5A24-P <input type="checkbox"/>	3 Phase 220V±15%	4.0/5.5	21/26	16/24	4.0/5.5
HC205D5A24-G <input type="checkbox"/> HC207D5A24-P <input type="checkbox"/>	3 Phase 220V±15%	5.5/7.5	26/35	24/33	5.5/7.5
HC207D5A24-G <input type="checkbox"/> HC20011A24-P <input type="checkbox"/>	3 Phase 220V±15%	7.5/11	35/46	33/47	7.5/11
HC20011A24-G <input type="checkbox"/> HC20015A24-P <input type="checkbox"/>	3 Phase 220V±15%	11/15	46/62	47/65	11/15
HC20015A24-G <input type="checkbox"/> HC20018A24-P <input type="checkbox"/>	3 Phase 220V±15%	15/18.5	62/76	65/80	15/18.5
HC20018A24-G <input type="checkbox"/> HC20022A24-P <input type="checkbox"/>	3 Phase 220V±15%	18.5/22	76/90	80/90	18.5/22
HC20022A24-G <input type="checkbox"/> HC20030A24-P <input type="checkbox"/>	3 Phase 220V±15%	22/30	90/105	90/136	22/30
HC20030A24-G <input type="checkbox"/> HC20037A24-P <input type="checkbox"/>	3 Phase 220V±15%	30/37	105/140	136/152	30/37
HC20037A24-G <input type="checkbox"/> HC20045A24-P <input type="checkbox"/>	3 Phase 220V±15%	37/45	140/160	152/176	37/45
HC20045A24-G <input type="checkbox"/> HC20055A24-P <input type="checkbox"/>	3 Phase 220V±15%	45/55	160/210	176/210	45/55
HC20055A24-G <input type="checkbox"/> HC20075A24-P <input type="checkbox"/>	3 Phase 220V±15%	55/75	210/290	210/305	55/75
HC20075A24-G <input type="checkbox"/> HC20090A24-P <input type="checkbox"/>	3 Phase 220V±15%	75/90	290/330	305/340	75/90

Model	Input Voltage	Rated Output Capacity (A)	Rated Input Current (A)	Rated Output Current (A)	Suitable Motor (KW)
HC20D75A48-G <input type="checkbox"/> HC201D5A48-P <input type="checkbox"/>	3 Phase 400V±15%	0.75/1.5	3.4/5	2.5/3.7	0.75/1.5
HC201D5A48-G <input type="checkbox"/> HC202D2A48-P <input type="checkbox"/>	3 Phase 400V±15%	1.5/2.2	5/5.8	3.7/5	1.5/2.2
HC202D2A48-G <input type="checkbox"/> HC204D0A48-P <input type="checkbox"/>	3 Phase 400V±15%	2.2/4.0	5.8/10	5/9.6	2.2/4.0
HC204D0A48-G <input type="checkbox"/> HC205D5A48-P <input type="checkbox"/>	3 Phase 400V±15%	4.0/5.5	10/15	9.6/12.5	4.0/5.5
HC205D5A48-G <input type="checkbox"/> HC207D5A48-P <input type="checkbox"/>	3 Phase 400V±15%	5.5/7.5	15/20	12.5/17.5	5.5/7.5
HC207D5A48-G <input type="checkbox"/> HC20011A48-P <input type="checkbox"/>	3 Phase 400V±15%	7.5/11	20/26	17.5/24	7.5/11
HC20011A48-G <input type="checkbox"/> HC20015A48-P <input type="checkbox"/>	3 Phase 400V±15%	11/15	26/35	24/33	11/15
HC20015A48-G <input type="checkbox"/> HC20018A48-P <input type="checkbox"/>	3 Phase 400V±15%	15/18.5	35/38	33/40	15/18.5
HC20018A48-G <input type="checkbox"/> HC20022A48-P <input type="checkbox"/>	3 Phase 400V±15%	18.5/22	38/46	40/47	18.5/22
HC20022A48-G <input type="checkbox"/> HC20030A48-P <input type="checkbox"/>	3 Phase 400V±15%	22/30	46/62	47/65	22/30
HC20030A48-G <input type="checkbox"/> HC20037A48-P <input type="checkbox"/>	3 Phase 400V±15%	30/37	62/76	65/80	30/37
HC20037A48-G <input type="checkbox"/> HC20045A48-P <input type="checkbox"/>	3 Phase 400V±15%	37/45	76/90	80/90	37/45
HC20045A48-G <input type="checkbox"/> HC20055A48-P <input type="checkbox"/>	3 Phase 400V±15%	45/55	90/105	90/110	45/55
HC20055A48-G <input type="checkbox"/> HC20075A48-P <input type="checkbox"/>	3 Phase 400V±15%	55/75	105/140	110/152	55/75
HC20075A48-G <input type="checkbox"/> HC20090A48-P <input type="checkbox"/>	3 Phase 400V±15%	75/90	140/160	152/176	75/90
HC20090A48-G <input type="checkbox"/> HC20110A48-P <input type="checkbox"/>	3 Phase 400V±15%	90/110	160/210	176/210	90/110
HC20110A48-G <input type="checkbox"/> HC20132A48-P <input type="checkbox"/>	3 Phase 400V±15%	110/132	210/240	210/255	110/132
HC20132A48-G <input type="checkbox"/> HC20160A48-P <input type="checkbox"/>	3 Phase 400V±15%	132/160	240/290	255/305	132/160

Model	Input Voltage	Rated Output Capacity (A)	Rated Input Current (A)	Rated Output Current (A)	Suitable Motor (KW)
HC20D75B24 □	1/3 Phase 220V±15%	0.75	8.2	4.5	0.75
HC201D5B24 □	1/3 Phase 220V±15%	1.5	14.2	7	1.5
HC202D2B24 □	3 Phase 220V±15%	2.2	18.4	10	2.2
HC204D0B24 □	3 Phase 220V±15%	4.0	21	16	4.0
HC205D5B24 □	3 Phase 220V±15%	5.5	26	24	5.5
HC207D5B24 □	3 Phase 220V±15%	7.5	35	33	7.5
HC20011B24 □	3 Phase 220V±15%	11	46	47	11
HC20015B24 □	3 Phase 220V±15%	15	62	65	15
HC20018B24 □	3 Phase 220V±15%	18	76	80	18
HC20022B24 □	3 Phase 220V±15%	22	90	90	22
HC20030B24 □	3 Phase 220V±15%	30	105	136	30
HC20037B24 □	3 Phase 220V±15%	37	140	152	37
HC20045B24 □	3 Phase 220V±15%	45	160	176	45
HC20055B24 □	3 Phase 220V±15%	55	210	210	55
HC20075B24 □	3 Phase 220V±15%	75	290	305	75
HC20D75B48 □	3 Phase 400V±15%	0.75	3.4	2.5	0.75
HC201D5B48 □	3 Phase 400V±15%	1.5	5.0	3.7	1.5
HC202D2B48 □	3 Phase 400V±15%	2.2	5.8	5	2.2
HC204D0B48 □	3 Phase 400V±15%	4.0	10	9.6	4.0
HC205D5B48 □	3 Phase 400V±15%	5.5	15	12.5	5.5
HC207D5B48 □	3 Phase 400V±15%	7.5	20	17.5	7.5
HC20011B48 □	3 Phase 400V±15%	11	26	24	11
HC20015B48 □	3 Phase 400V±15%	15	35	33	15
HC20018B48 □	3 Phase 400V±15%	18.5	38	40	18.5
HC20022B48 □	3 Phase 400V±15%	22	46	47	22
HC20030B48 □	3 Phase 400V±15%	30	62	65	30
HC20037B48 □	3 Phase 400V±15%	37	76	80	37
HC20045B48 □	3 Phase 400V±15%	45	90	90	45
HC20055B48 □	3 Phase 400V±15%	55	105	110	55
HC20075B48 □	3 Phase 400V±15%	75	140	152	75
HC20090B48 □	3 Phase 400V±15%	90	160	176	90
HC20110B48 □	3 Phase 400V±15%	110	210	210	110
HC20132B48 □	3 Phase 400V±15%	132	240	255	132

Outline and Installation Dimension:

◆ A1000、B1000 2.2kw

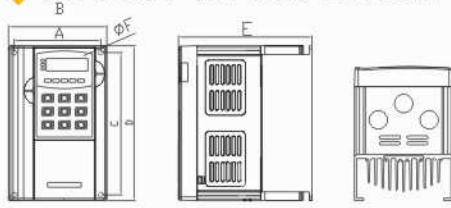

◆ A1000、B1000 4.0-5.5kw

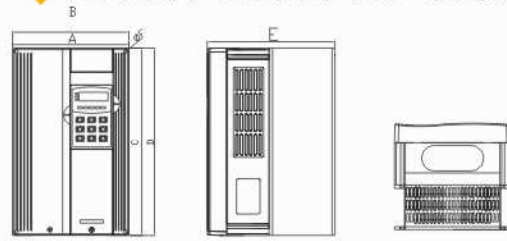

◆ A1000、B1000 7.5-11kw

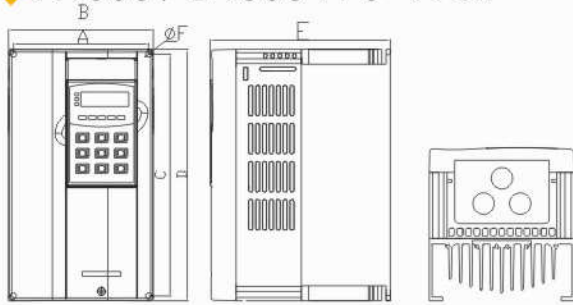

◆ A1000、B1000 Over 15kw

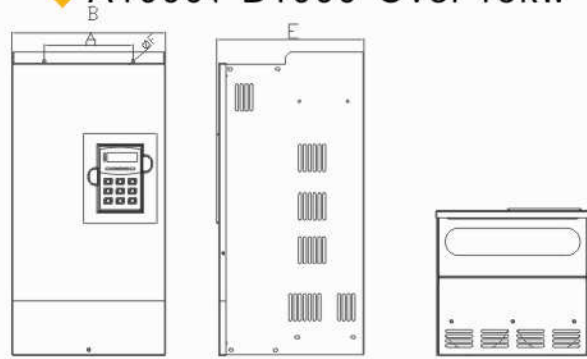

◆ External Panel

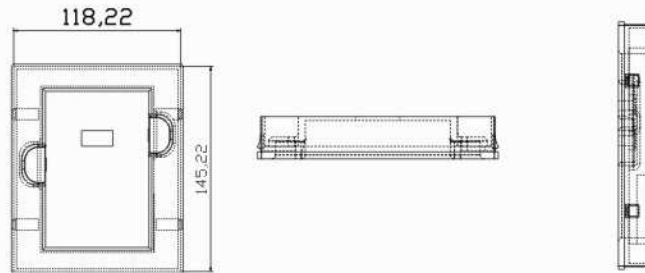

Extended Cable: 1M, 2M, 3M

unit: mm

Model	A	B	C	D	E	ØF	Install	Remark
HC20D75A24-G <input type="checkbox"/>	104	118	175	185	160	6	Case-in	
HC201D5A24-P <input type="checkbox"/>	104	118	175	185	160	6	Case-in	
HC201D5A24-G <input type="checkbox"/>	104	118	175	185	160	6	Case-in	
HC202D2A24-P <input type="checkbox"/>	106	118	175	185	160	6	Case-in	
HC202D2A24-G <input type="checkbox"/>	106	118	175	185	160	6	Case-in	
HC204D0A24-P <input type="checkbox"/>	138	151	244	260	160	6	Case-in	
HC204D0A24-G <input type="checkbox"/>	138	151	244	260	160	6	Case-in	
HC205D5A24-P <input type="checkbox"/>	138	151	244	260	160	6	Case-in	
HC205D5A24-G <input type="checkbox"/>	138	151	244	260	160	6	Case-in	
HC207D5A24-P <input type="checkbox"/>	183	200	303	323	183	6	Case-in	
HC207D5A24-G <input type="checkbox"/>	183	200	303	323	183	6	Case-in	
HC20011A24-P <input type="checkbox"/>	183	200	303	323	183	6	Case-in	
HC20011A24-G <input type="checkbox"/>	183	200	303	323	183	6	Case-in	
HC20015A24-P <input type="checkbox"/>	147	251	475	500	240	6	Case-in	
HC20015A24-G <input type="checkbox"/>	147	251	475	500	240	6	Case-in	
HC20018A24-P <input type="checkbox"/>	147	251	475	500	240	6	Case-in	
HC20018A24-G <input type="checkbox"/>	147	251	475	500	240	6	Case-in	
HC20022A24-P <input type="checkbox"/>	147	251	475	500	240	6	Case-in	
HC20022A24-G <input type="checkbox"/>	147	251	475	500	240	6	Case-in	
HC20030A24-P <input type="checkbox"/>	147	251	475	500	240	6	Case-in	

Model	A	B	C	D	E	ØF	Install	Remark
HC20030A24-G <input type="checkbox"/>	197	301	482	500	260	6	Case-in	
HC20037A24-P <input type="checkbox"/>								
HC20037A24-G <input type="checkbox"/>	197	301	482	500	260	6	Case-in	
HC20045A24-P <input type="checkbox"/>								
HC20045A24-G <input type="checkbox"/>	240	360	625	650	280	6	Case-in	
HC20055A24-P <input type="checkbox"/>								
HC20055A24-G <input type="checkbox"/>	240	360	625	650	280	6	Case-in	
HC20075A24-P <input type="checkbox"/>								
HC20075A24-G <input type="checkbox"/>	260	420	775	800	334	8	Case-in	
HC20090A24-P <input type="checkbox"/>								
HC20D75A48-G <input type="checkbox"/>	80	118	169	185	160	6	Case-in	
HC201D5A48-P <input type="checkbox"/>								
HC201D5A48-G <input type="checkbox"/>	80	118	169	185	160	6	Case-in	
HC202D2A48-P <input type="checkbox"/>								
HC202D2A48-G <input type="checkbox"/>	80	118	169	185	160	6	Case-in	
HC204D0A48-P <input type="checkbox"/>								
HC204D0A48-G <input type="checkbox"/>	88	151	222	260	160	6	Case-in	
HC205D5A48-P <input type="checkbox"/>								
HC205D5A48-G <input type="checkbox"/>	88	151	222	260	160	6	Case-in	
HC207D5A48-P <input type="checkbox"/>								
HC207D5A48-G <input type="checkbox"/>	187	200	303	323	183	6	Case-in	
HC20011A48-P <input type="checkbox"/>								
HC20011A48-G <input type="checkbox"/>	187	200	303	323	183	6	Case-in	
HC20015A48-P <input type="checkbox"/>								
HC20015A48-G <input type="checkbox"/>	147	251	475	500	240	6	Case-in	
HC20018A48-P <input type="checkbox"/>								
HC20018A48-G <input type="checkbox"/>	147	251	475	500	240	6	Case-in	
HC20022A48-P <input type="checkbox"/>								
HC20022A48-G <input type="checkbox"/>	147	251	475	500	240	6	Case-in	
HC20030A48-P <input type="checkbox"/>								
HC20030A48-G <input type="checkbox"/>	197	301	482	500	260	6	Case-in	
HC20037A48-P <input type="checkbox"/>								
HC20037A48-G <input type="checkbox"/>	197	301	482	500	260	6	Case-in	
HC20045A48-P <input type="checkbox"/>								
HC20045A48-G <input type="checkbox"/>	240	360	625	650	280	6	Case-in	
HC20055A48-P <input type="checkbox"/>								
HC20055A48-G <input type="checkbox"/>	240	360	625	650	280	6	Case-in	
HC20075A48-P <input type="checkbox"/>								
HC20075A48-G <input type="checkbox"/>	260	420	775	800	334	8	Case-in	
HC20090A48-P <input type="checkbox"/>								
HC20090A48-G <input type="checkbox"/>	260	420	775	800	334	8	Case-in	
HC20110A48-P <input type="checkbox"/>								
HC20110A48-G <input type="checkbox"/>	Please contact the agents for 110KW or above.							
HC20132A48-P <input type="checkbox"/>								
HC20132A48-G <input type="checkbox"/>								
HC20160A48-P <input type="checkbox"/>								

Model	A	B	C	D	E	ØF	Install	Remark
HC20D75B24 <input type="checkbox"/>	104	118	175	185	160	6	Case-in	
HC201D5B24 <input type="checkbox"/>	104	118	175	185	160	6	Case-in	
HC202D2B24 <input type="checkbox"/>	106	118	175	185	160	6	Case-in	
HC204D0B24 <input type="checkbox"/>	138	151	244	260	160	6	Case-in	
HC205D5B24 <input type="checkbox"/>	138	151	244	260	160	6	Case-in	
HC207D5B24 <input type="checkbox"/>	183	200	303	323	183	6	Case-in	
HC20011B24 <input type="checkbox"/>	183	200	303	323	183	6	Case-in	
HC20015B24 <input type="checkbox"/>	147	251	475	500	240	6	Case-in	
HC20018B24 <input type="checkbox"/>	147	251	475	500	240	6	Case-in	
HC20022B24 <input type="checkbox"/>	147	251	475	500	240	6	Case-in	
HC20030B24 <input type="checkbox"/>	197	301	482	500	260	6	Case-in	
HC20037B24 <input type="checkbox"/>	197	301	482	500	260	6	Case-in	
HC20045B24 <input type="checkbox"/>	240	360	625	650	280	6	Case-in	
HC20055B24 <input type="checkbox"/>	240	360	620	650	280	8	Case-in	
HC20075B24 <input type="checkbox"/>	260	420	775	800	334	8	Case-in	
HC20D75B48 <input type="checkbox"/>	80	118	169	185	160	6	Case-in	
HC201D5B48 <input type="checkbox"/>	80	118	169	185	160	6	Case-in	
HC202D2B48 <input type="checkbox"/>	80	118	169	185	160	6	Case-in	
HC204D0B48 <input type="checkbox"/>	88	151	222	260	160	6	Case-in	
HC205D5B48 <input type="checkbox"/>	88	151	222	260	160	6	Case-in	
HC207D5B48 <input type="checkbox"/>	187	200	303	323	183	6	Case-in	
HC20011B48 <input type="checkbox"/>	187	200	303	323	183	6	Case-in	
HC20015B48 <input type="checkbox"/>	147	251	475	500	240	6	Case-in	
HC20018B48 <input type="checkbox"/>	147	251	475	500	240	6	Case-in	
HC20022B48 <input type="checkbox"/>	147	251	475	500	240	6	Case-in	
HC20030B48 <input type="checkbox"/>	197	301	482	500	260	6	Case-in	
HC20037B48 <input type="checkbox"/>	197	301	482	500	260	6	Case-in	
HC20045B48 <input type="checkbox"/>	240	360	625	650	280	6	Case-in	
HC20055B48 <input type="checkbox"/>	240	360	620	650	280	8	Case-in	
HC20075B48 <input type="checkbox"/>	260	420	775	800	334	8	Case-in	
HC20090B48 <input type="checkbox"/>	260	420	775	800	334	8	Case-in	
HC20110B48 <input type="checkbox"/>	Please contact the agents for 110KW or above.							

Accessories



Input / Output AC reactor

220V		
Input reactor Part No	Power (KW)	Output reactor Part No
ACL-L0.4	0.4	ACL-LO0.4
ACL-L0.75	0.75	ACL-LO0.75
ACL-L1.5	1.5	ACL-LO1.5
ACL-L2.2	2.2	ACL-LO2.2
ACL-L3.7	3.7	ACL-LO3.7
ACL-L5.5	5.5	ACL-LO5.5
ACL-L7.5	7.5	ACL-LO7.5
ACL-L11	11	ACL-LO11
ACL-L15	15	ACL-LO15
ACL-L18	18.5	ACL-LO18
ACL-L22	22	ACL-LO22
ACL-L30	30	ACL-LO30
ACL-L37	37	ACL-LO37
ACL-L55	55	ACL-LO55
ACL-L75	75	ACL-LO75

400V		
Input reactor Part No	Power (KW)	Output reactor Part No
ACL-H0.75	0.75	ACL-HO0.75
ACL-H1.5	1.5	ACL-HO1.5
ACL-H2.2	2.2	ACL-HO2.2
ACL-H3.7	3.7	ACL-HO3.7
ACL-H5.5	5.5	ACL-HO5.5
ACL-H7.5	7.5	ACL-HO7.5
ACL-H11	11	ACL-HO11
ACL-H15	15	ACL-HO15
ACL-H18	18.5	ACL-HO18
ACL-H22	22	ACL-HO22
ACL-H30	30	ACL-HO30
ACL-H37	37	ACL-HO37
ACL-H55	55	ACL-HO55
ACL-H75	75	ACL-HO75
ACL-H90	90	ACL-HO90
ACL-H110	110	ACL-HO110
ACL-H132	132	ACL-HO132
ACL-H160	160	ACL-HO160
ACL-H185	185	ACL-HO185
ACL-H200	200	ACL-HO200
ACL-H220	220	ACL-HO220
ACL-H250	250	ACL-HO250
ACL-H280	280	ACL-HO280
ACL-H300	300	ACL-HO300
ACL-H315	315	ACL-HO315

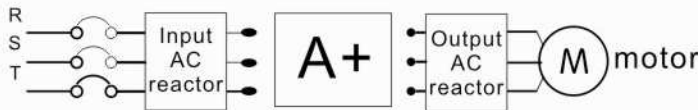

Input / Output AC Filter

220V		
Input Filter Part No	Power (KW)	Output Filter Part No
NFS32010	0.4~1.5	RFI 32010
NFS32020	2.2~3.7	RFI 32020
NFS32040	5.5	RFI 32040
NFS32060	7.5~11	RFI 32060
NFS32090	15~18.5	RFI 32090
NFS32130	22	RFI 32130
NFS32180	30~37	RFI 32180
NFS32220	40	RFI 32220
NFS32270	55	RFI 32270
NFS32400	75	RFI 32400

400V		
Input Filter Part No	Power (KW)	Output Filter Part No
NFS34010	0.75~3.7	RFI 34010
NFS34020	5.5~7.5	RFI 34020
NFS34040	11~15	RFI 34040
NFS34060	18.5~22	RFI 34060
NFS34090	30~37	RFI 34090
NFS34130	40~55	RFI 34130
NFS34180	75	RFI 34180
NFS34220	90	RFI 34220
NFS34270	110	RFI 34270
NFS34320	132	RFI 34320
NFS34400	150	RFI 34400

Accessories

Sin Wave Filter

400V	
Part No	Power (KW)
TESFR44001	0.75
TESFR44002	1.5
TESFR44003	2.2
TESFR44005	3.7
TESFR44007	5.5
TESFR44010	7.5
TESFR44015	11
TESFR44020	15
TESFR44025	18.5
TESFR44030	22
TESFR44040	30
TESFR44050	37
TESFR44060	45
TESFR44075	55
TESFR44100	75
TESFR44120	90
TESFR44150	110
TESFR44200	150
TESFR44250	185
TESFR44300	220
TESFR44400	300

Application Range: frequency inverter at output side
 Working field: altitude of less than 1000 meter inside
 Temperature: maximum less than 40 degrees,
 average less than 35 degrees in one whole day
 Phase frequency: 3-phase 60Hz
 Input voltage: 380 ~ 480V
 Carrier frequency: 5KHz ~ 10KHz
 Functional effectiveness:
 1. dv/dv protection
 2. overcurrent protection
 3. reduce noise and temperature of motors
 4. prolong lifetime of motors

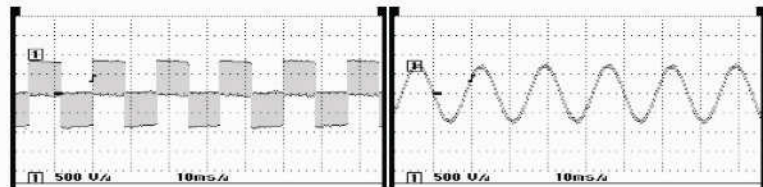

Harmonic Filter



Confirmed Effectiveness:
 total harmonic distortion
 THDi = less than 12%
 (THDi = 8% or 5% is agreed as well)
 Power Factor Cosθ = more than 0.95

400V	
Part No	Power (KW)
TEHRF94020-12	15
TEHRF94025-12	18.5
TEHRF94030-12	22
TEHRF94040-12	30
TEHRF94050-12	37
TEHRF94060-12	45
TEHRF94075-12	55
TEHRF940100-12	75
TEHRF940120-12	90
TEHRF940150-12	110
TEHRF940200-12	160
TEHRF940250-12	185
TEHRF940300-12	220
TEHRF940400-12	300

Zero-Phase Filter

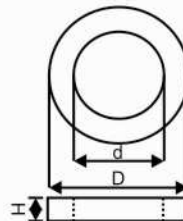

Part No	d	D	H
ZFM5038D	38	63	12.5
ZFM5050D	50	80	20

Frequency Meter Current Meter



VR-2K Dial BM-20



Braking Unit



220V	400V
CDBR-2015	CDBR-4030
CDBR-2022	CDBR-4045
CDBR-2110	CDBR-4220

● Breaking Resistor



Controller Type	Braking resistance		CDBR	Torsion (10% ED)	KW
	W	Ω			
220V 0.4KW	80	200		220	0.4
220V 0.75KW	100	200		125	0.7
220V 1.5KW	300	100		125	1.5
220V 2.2KW	300	70		120	2.2
220V 3.7KW	390	40		125	3.7
220V 5.5KW	520	30		115	5.5
220V 7.5KW	780	20		125	7.5
220V 11KW	2400	13.6	2015	125	11
220V 15KW	3000	10	2015	125	15
220V 18KW	4800	8	2022	125	18
220V 22KW	4800	6.8	2022	125	22
220V 30KW	3000x2	10x2	2015x2	125	30
220V 37KW	3000x2	10x2	2015x2	100	37
220V 45KW	4800x2	6.8x2	2022x2	120	45
220V 55KW	4800x2	6.8x2	2022x2	100	55
220V 75KW	4800x3	6.8x3	2022x3	110	75
400V 0.75KW	80	750		130	0.7
400V 1.5KW	300	400		125	1.5
400V 2.2KW	300	250		135	2.2
400V 3.7KW	400	150		135	3.7
400V 5.5KW	500	100		135	5.5
400V 7.5KW	1000	75		130	7.5
400V 11KW	1000	50		135	11
400V 15KW	1500	40		125	15
400V 15KW	1500	40	4030x1	125	15
400V 18KW	4800	32	4030x1	125	18
400V 22KW	4800	27.2	4030x1	125	22
400V 30KW	6000	20	4030x1	125	30
400V 37KW	9600	16	4045x1	125	37
400V 45KW	9600	13.6	4045x1	125	45
400V 55KW	6000x2	20	4045x2	135	55
400V 75KW	9600x2	13.6	4045x2	145	75
400V 90KW	9600x3	20	4045x3	120	90
400V 110KW	9600x3	13.6	4045x3	100	110

B1000 Application

Shift platform
X-Y Table

Iron and Steel Industry

Perfect low frequency output torque makes steel rolling production line runs freely and smoothly.

Textile Industry

VG AC motor controller can always satisfy the demands of spinning frame, roving frame, and synchronous control.

Paper Industry

The winding of paper has a very high demand for tension fluctuation. Precise torque calculation enables the torque have a smooth output and prompt response.

Printing and Packaging

The printing machinery requires the AC motor controller for prompt response. VG high-speed response performance can completely meet the demands.

Tools & Plastic industry

Fan / Pump

Constant pressure water supply and air supply, specialized fan of coking furnace, air compressor, etc.

Metal Industry

Closed loop tuning function with prefixed speed setting can achieve prompt response, stable operation, simple and reliable control in the synchronous tension control system such as direct-running wire drawing machine.



Application Industry

A1000 Application

Air conditioner, Waste Water System, Water supply system for building and area

Basic Wiring Diagram of A1000, B1000 series

(1) 15KW model or under

(2) 18.5KW model or above

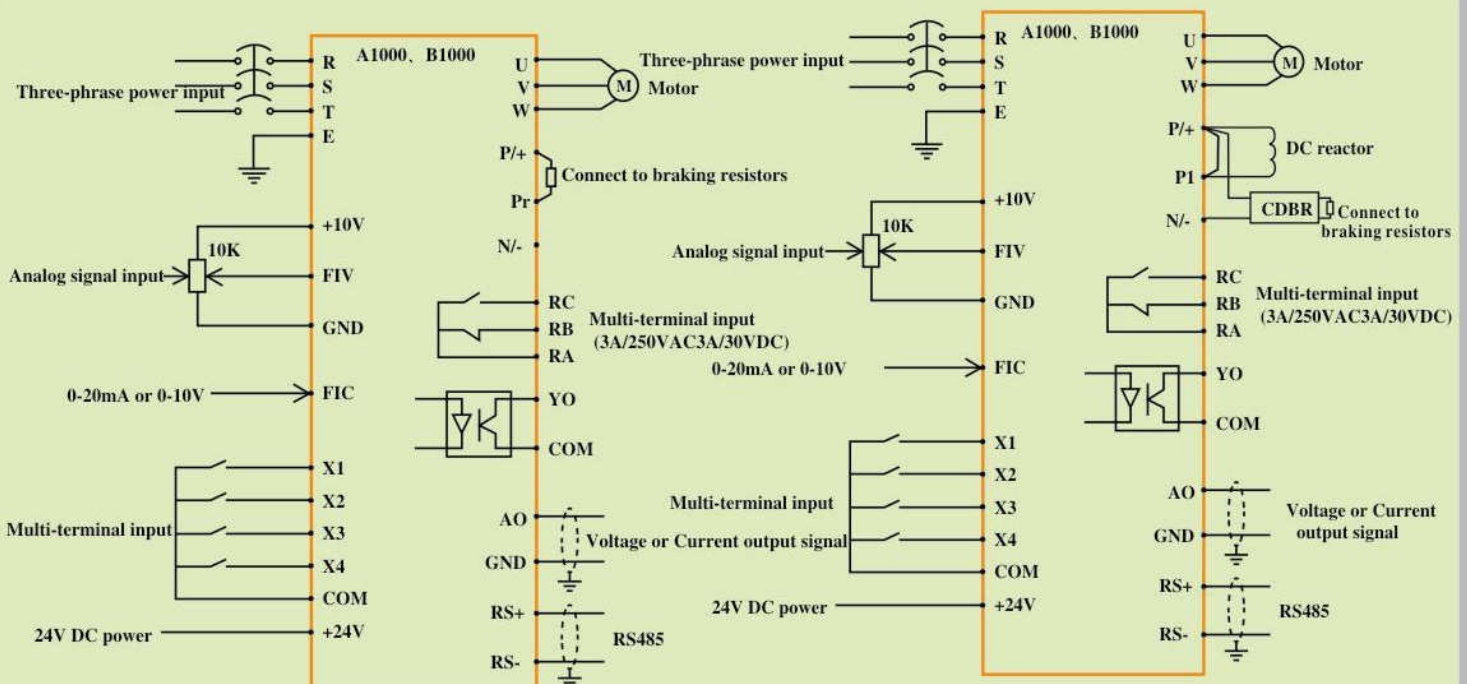

Wiring Diagram