

RoHS
Compliant
2002/95/EC

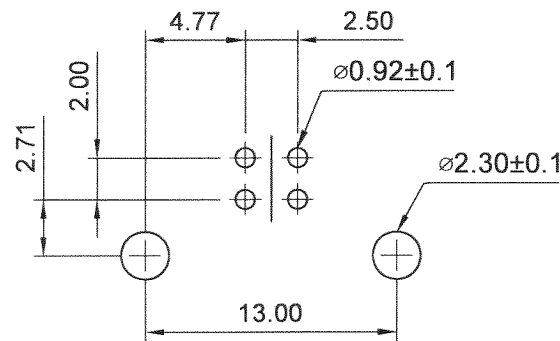
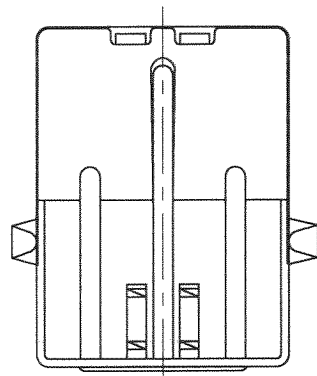
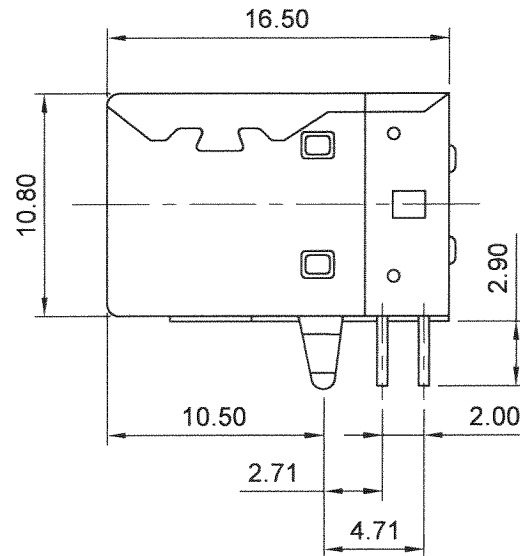
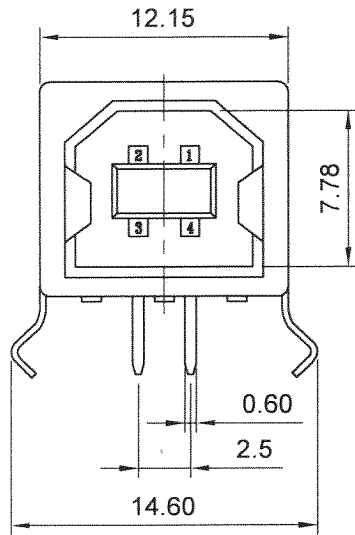

RECOMMENDED P.C.B PATTERN LAYOUT

1. MATERIAL :
INSULATOR : PBT + 30%G.F UL 94V-0
CONTACT : PHOSPHOR BRONZE
SHELL : BRASS
2. MECHANICAL :
MATING : 35N MAX
WITHDRAWAL FORCE : 10N MIN
DURAL ILITY : 1500 CYCLES MIN
3. ELECTRICAL :
CURRENT-MAX : 1.0A
VOLTAGE-MAX : 30V
WITHSTANDING VOLTAGE : 100V AC
CONTACT RESISTANCE : 50mΩ MAX
INSULATION RESISTANCE : 1000MΩ MIN
4. PLATING :
CONTACTS : GOLD FLASH AND TIN OVER NICKEL PLATED
SHELL : NICKE (TIN) OVER ALL PLATING
5. ENVIRONMENTAL :
TEMPERATURE RANGE : -25°C TO +85°C

USB-B/F/R

JAWS 兆旭股份有限公司
JAWS CO., LTD.

7F-1, NO.31, Lane 169, Kang Ning Street,
Hsichih, Taipei Hsien, Taiwan.
TEL:886-2-2692-2898
FAX:886-2-2692-2618
Http://www.jaws.com.tw

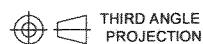

THIRD ANGLE
PROJECTION

DESIGN UNITS
■ mm □ INCH

TITLE:

USB B TYPE DIP 90° FEMALE

GENERAL TOLERANCES :

±0.30

SIZE:

A4

SCALE:

FREE

SHEET:

1/1

PARTS NO.:

UBH104GADSV1

DWG NO.:

JAWS-SOP-UB001

REV.

01

DRAWN

游熾瑩

DATE 96/11/15

CHECK

DATE 96/11/16

APPROVE

DATE 96.11.17