

RoHS
Compliant
2002/95/EC

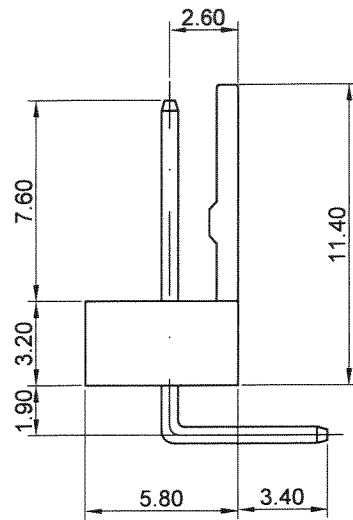

SPECIFICATIONS
 CURRENT RATING : 2A AC, DC
 VOLTAGE RATING : 250 AC MAXIMUM
 OPERATING TEMP : -25°C ~ + 85°C
 CONTACT RESISTANCE : 10 mΩ MAX
 INSULATION RESISTANCE : 1000 MΩ MIN
 TERMINAL MATERIAL : BRASS/ TIN-PLATED/GOLD-PLATED
 MATERIAL : NYLON 66, UL94V-2

POLES	DIMENSION mm	
	A	B
2	2.54	5.12
3	5.08	7.66
4	7.62	10.20
5	10.16	12.74
6	12.70	15.30
7	15.24	17.94
8	17.78	20.48
9	20.32	23.02
10	22.86	25.58
11	25.40	28.12
12	27.94	30.68
13	30.48	33.10
14	33.02	35.80
15	35.56	38.34
16	38.10	40.94
17	40.64	43.30
18	43.18	45.90
19	45.72	48.56
20	48.26	50.80

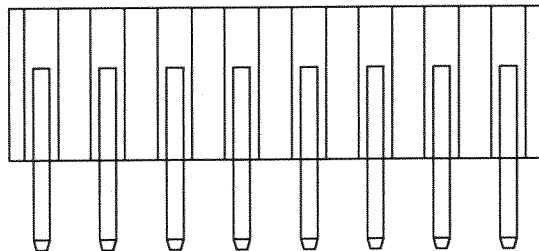
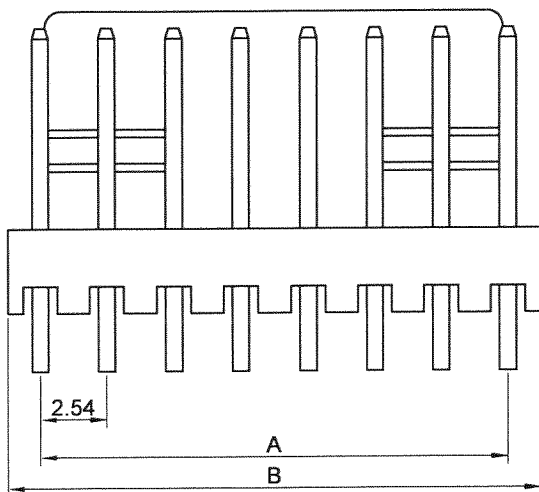
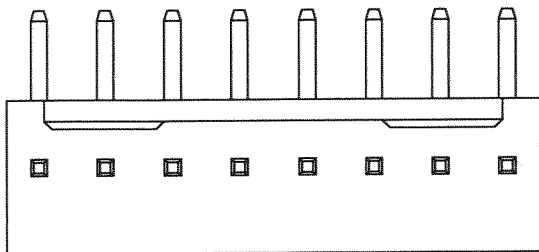
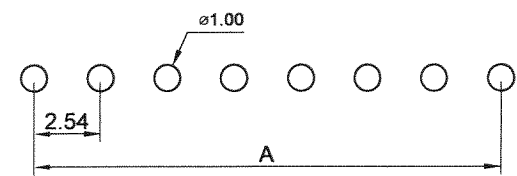

RECOMMENDED P.C. BOARD HOLE DIMM.

JAWS® 兆旭股份有限公司
 JAWS CO., LTD.
 7F-1, NO.31, Lane 169, Kang Ning Street,
 Hsichih, Taipei Hsien, Taiwan.
 TEL: 886-2-2692-2898
 FAX: 886-2-2692-2618
 Http://www.jaws.com.tw

THIRD ANGLE PROJECTION
 DESIGN UNITS: mm INCH
 SIZE: **A4** SCALE: **FREE** SHEET: **1/1**
 CPN NO.:
 DAN NO.: **S9709-047**

TITLE: **2.54mm WIRE-TO-BOARD HEADER
 DIP 90° TYPE**
 PARTS NO.: **250E-WR-xxT**
 DWG NO.: **JAWS-SOP-250E003**
 REV.: **01**

GENERAL TOLERANCES: **±0.30**

DRAWN	游熾瑩	DATE	97/09/23
CHECK	郭坤瑩	DATE	97.9.23
APPROVE	陳世宜	DATE	97.9.24