

C-TEK 1.27MM PITCH PIN HEADER

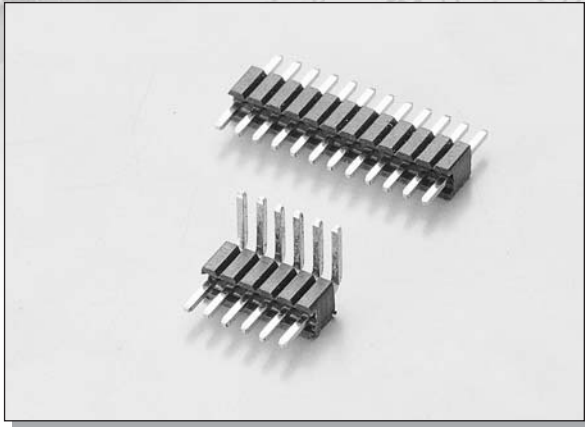

MATERIAL:

INSULATOR : PBT + 30% GLASS FIBER,
UL 94V-0 RATED.

CONTACT : PHOSPHOR BRONZE OR BRASS.
(STANDARD IS BRASS)

ELECTRICAL CHARACTERISTICS:

CURRENT RATING : 1 AMP.
WITHSTANDING VOLTAGE : AC 750V R.M.S.
INSULATOR RESISTANCE : 5000 MEGOHMS MIN.
CONTACT RESISTANCE : 20 MILLIOHMS MAX.
OPERATING TEMPERATURE : -55°C ~ +105°C

DIMENSIONS

DOUBLE ROWS-STRAIGHT

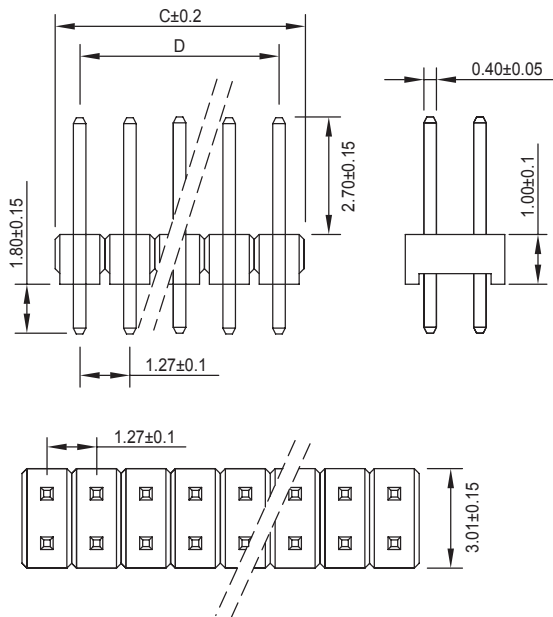

SINGLE ROW-STRAIGHT

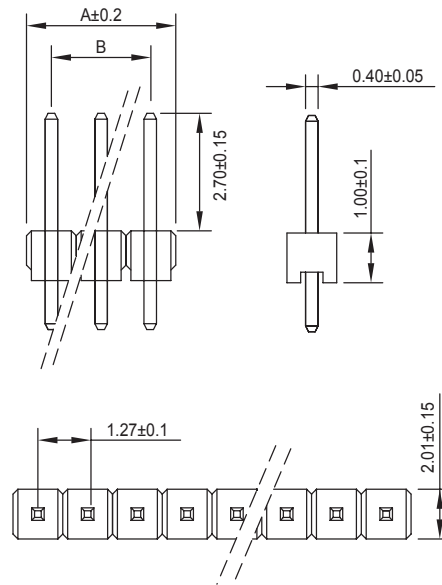

DIMENSIONS

A=1.27 x (No. of Positions-1)+1.67
B=1.27 x (No. of Position-1)
C=1.27 x (No. of Position/2-1)+1.67
D=1.27 x (No. of Position/2-1)

HOW TO ORDER

SERIES NO.	PITCH	CONTACT NO	CONTACT TYPE	PLATING	HOUSING MATERIAL	REMOVE PIN
5005	A A: 1.27 x 2.54 B: 1.27 x 1.27	2 x 6 1 x 2P ~ 1 x 40P 2 x 2P ~ 2 x 40P	R R: R/A S: STRAIGHT M: SMT	G G: GOLD PLATED S: SELECTIVE GOLD PLATED	P P: PBT H: HIGH TEMP.	1 BLANK: FULL PIN 1-80P (pls indicate remove pin no.)