

# .109"(2.77mm) pitch DIP SOLDER D-SUB Connector



## MATERIAL

- \* Insulator: PBT+30% Glass Fiber UL94V-0
- \* Pin Contact: Brass Gold/Tin Plated

## ELECTRICAL

- \* Rated Current: 5A
- \* Rated Voltage: 350V AC
- \* Withstand Voltage: 500V AC(RMS)
- \* Insulation resistance: Over 1,000 MΩ
- \* Temperature range: -40°C ~ +100°C

## Accessories

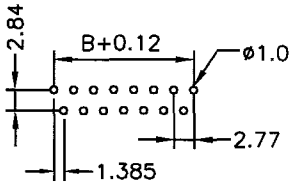
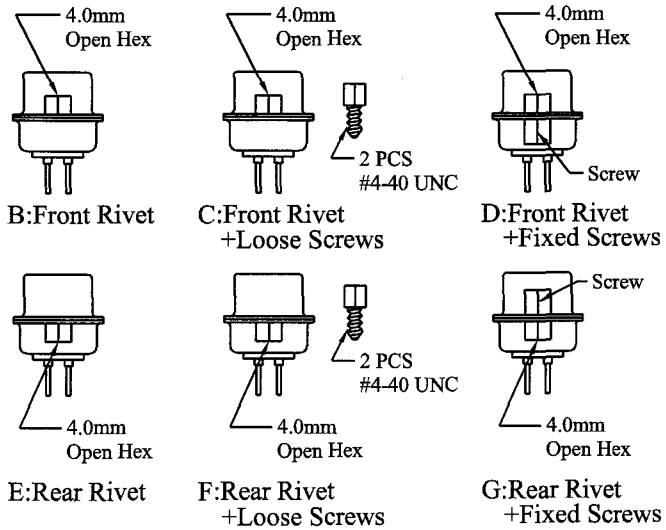

P.C. Board Layout

## FEMALE SERIES

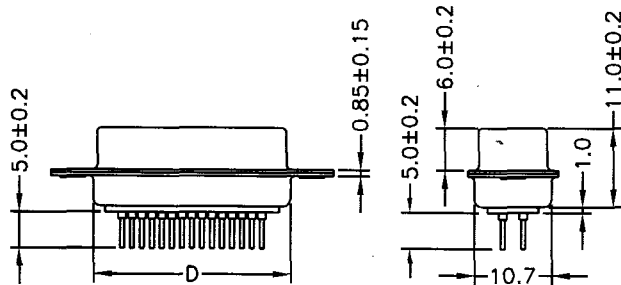
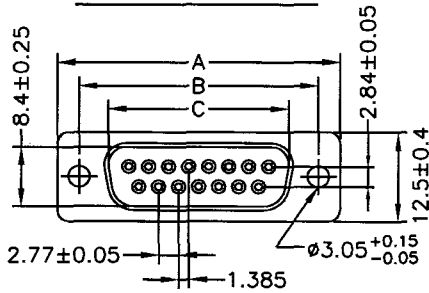

## MALE SERIES

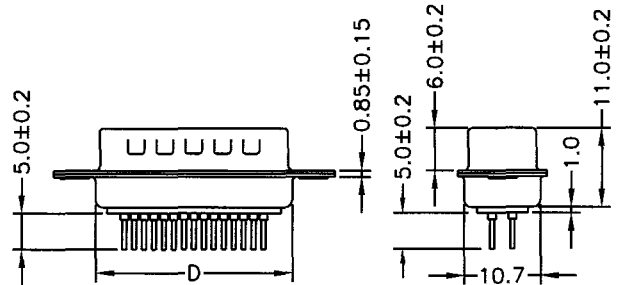
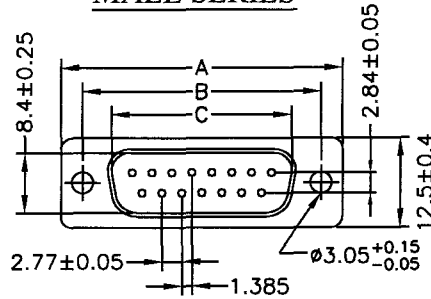

CIRCUITS	FEMALE DIMENSION			
	A±0.2	B±0.2	C±0.2	D±0.2
9	30.9	25.0	16.3	19.3
15	39.2	33.3	24.7	27.6
25	53.0	47.1	38.5	41.3
37	69.4	63.6	54.9	57.5
50	66.9	61.1	52.4	53.3

CIRCUITS	MALE DIMENSION			
	A±0.2	B±0.2	C±0.2	D±0.2
9	30.9	25.0	16.9	19.3
15	39.2	33.3	25.2	27.6
25	53.1	47.1	39.0	41.2
37	69.4	63.6	55.4	57.6
50	66.9	61.1	52.8	55.3

## ORDERING CODE

DS50 - 25 M X X X X X X

- SERIES NO.  
D-SUB DIP SOLDER TYPE
- CONTACT NO:  
09. 15. 25. 37. 50
- CONTACT TYPE:  
M=MALE  
F=FEMALE
- MOUNTING OPTION:  
A=THROUGH HOLE Ø3.05mm  
B=HEX SCREW+1.5mm NUT  
C=4.0mm OPEN HEX RIVET  
D=6.0mm OPEN HEX RIVET  
F=6.0mm CLOSE HEX RIVET  
I=6.0mm BOARDLOCK RIVET

- ACCESSORIES:  
A=NON ACCESSORIES  
B=FRONT RIVET  
C=FRONT RIVET+LOOSE SCREW  
D=FRONT RIVET+FIXED SCREW  
E=REAR RIVET  
F=REAR RIVET+LOOSE SCREW  
G=REAR RIVET+FIXED SCREW  
J=ADD SCREWS
- SHELL PLATING:  
T=TIN  
N=NICKEL  
Z=ZINC (CHROMATED)

- CONTACT PLATING:  
S=SELECTIVE GOLD  
A=GOLD 5u"/TIN  
B=GOLD 10u"/TIN  
C=GOLD 15u"/TIN  
D=GOLD 30u"/TIN  
G=GOLD FLASH  
H=GOLD 5u"  
I=GOLD 10u"  
J=GOLD 15u"  
K=GOLD 30u"
  - INSULATOR COLOR:  
B=BLACK(STANDARD)  
W=WHITE  
L=BLUE
- REMARK:NO.OF CIRCUITS 50 IS 3 ROW  
PACKAGING=TRAY