

.109" (2.77mm) pitch DIP SOLDER D-SUB Connector



MATERIAL

- * Insulator: PBT+30% Glass Fiber UL94V-0
- * Pin Contact: Brass Gold/Tin Plated

ELECTRICAL

- * Rated Current: 5A
- * Rated Voltage: 350V AC
- * Withstand Voltage: 500V AC (RMS)
- * Insulation resistance: Over 1,000 MΩ
- * Temperature range: -40°C ~ +100°C

Accessories

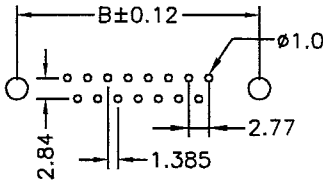
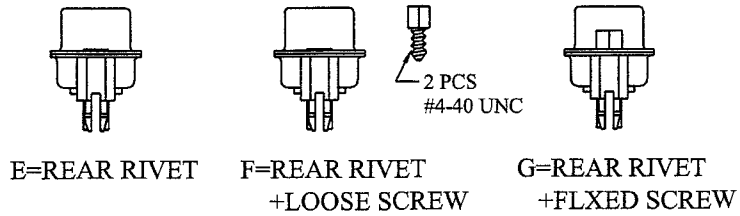

P.C. Board Layout

FEMALE SERIES

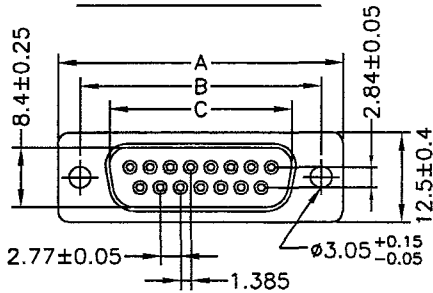

MALE SERIES

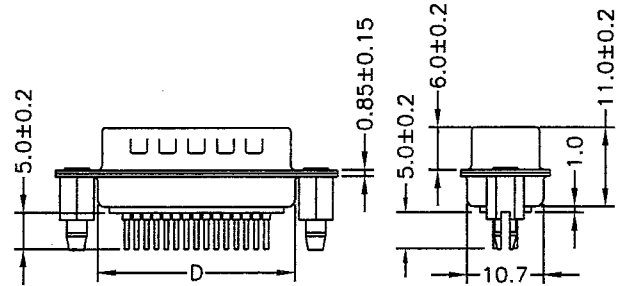
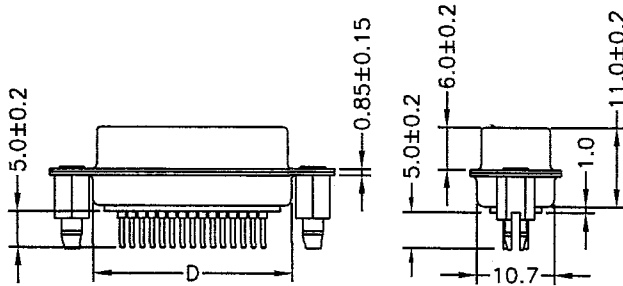
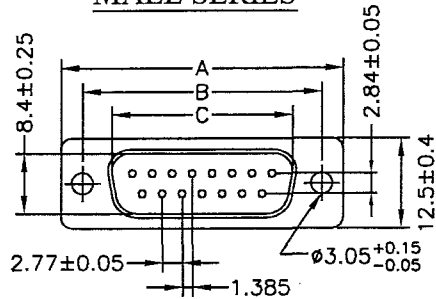

CIRCUITS	FEMALE DIMENSION			
	A±0.2	B±0.2	C±0.2	D±0.2
9	30.9	25.0	16.3	19.3
15	39.2	33.3	24.7	27.6
25	53.0	47.1	38.5	41.3
37	69.4	63.6	54.9	57.5
50	66.9	61.1	52.4	53.3

CIRCUITS	MALE DIMENSION			
	A±0.2	B±0.2	C±0.2	D±0.2
9	30.9	25.0	16.9	19.3
15	39.2	33.3	25.2	27.6
25	53.1	47.1	39.0	41.2
37	69.4	63.6	55.4	57.6
50	66.9	61.1	52.8	55.3

ORDERING CODE

DS50 - 25 M I X X X X X

1 2 3 4 5 6 7 8

- | | | |
|--|--|---|
| <ol style="list-style-type: none"> SERIES NO.
D-SUB DIP SOLDER TYPE CONTACT NO:
09, 15, 25, 37, 50 CONTACT TYPE:
M=MALE
F=FEMALE MOUNTING
I=6.0mm BOARDLOCK RIVET ACCESSORIES:
E=REAR RIVET
F=REAR RIVET+LOOSE SCREW
G=REAR RIVET+FIXED SCREW | <ol style="list-style-type: none"> SHELL PLATING:
T=TIN
N=NICKEL
Z=ZINC (CHROMATED) CONTACT PLATING:
S=SELECTIVE GOLD G=GOLD FLASH
A=GOLD 5u"/TIN H=GOLD 5u"
B=GOLD 10u"/TIN I=GOLD 10u"
C=GOLD 15u"/TIN J=GOLD 15u"
D=GOLD 30u"/TIN K=GOLD 30u" | <ol style="list-style-type: none"> INSULATOR COLOR:
B=BLACK(STANDARD)
W=WHITE
L=BLUE <p>REMARK:NO.OF CIRCUITS 50 IS 3 ROW
PACKAGING=TRAY</p> |
|--|--|---|