

.100"(2.54mm) pitch FFC/FPC connectors



CH2542A Series

- * Poles: 2 ~ 40
- * Material: PBTP UL94V-0 BLACK
- * Suitable CT2542 series terminal
- * Mates with CW328X series pin Header

Specifications

- * Current rating: 3A AC, DC
- * Voltage rating: 250V AC, DC
- * Temperature range: -25°C~+85°C
- * Insulation resistance: 1,000MΩ min.
- * Withstand voltage: 1,000V AC/minute

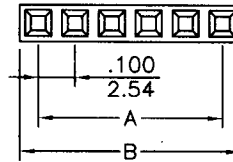

inches
mm

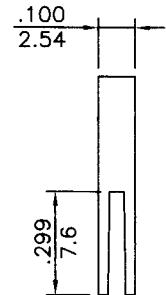
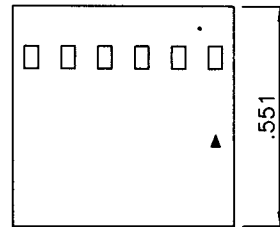

CIRCUITS	PART NO.	DIMENSION		CIRCUITS	PART NO.	DIMENSION	
		A	B			A	B
2	CH2542A-02	0.100(2.54)	0.200(5.08)	15	CH2542A-15	1.400(35.54)	1.500(38.10)
3	CH2542A-03	0.200(5.08)	0.300(7.62)	16	CH2542A-16	1.500(38.10)	1.600(40.64)
4	CH2542A-04	0.300(7.62)	0.400(10.16)	17	CH2542A-17	1.600(40.64)	1.700(43.18)
5	CH2542A-05	0.400(10.16)	0.500(12.70)	18	CH2542A-18	1.700(43.18)	1.800(45.72)
6	CH2542A-06	0.500(12.70)	0.600(15.24)	19	CH2542A-19	1.800(45.72)	1.900(48.26)
7	CH2542A-07	0.600(15.24)	0.700(17.78)	20	CH2542A-20	1.900(48.26)	2.000(50.80)
8	CH2542A-08	0.700(17.78)	0.800(20.32)	21	CH2542A-21	2.000(50.80)	2.100(53.34)
9	CH2542A-09	0.800(20.32)	0.900(22.86)	22	CH2542A-22	2.100(53.34)	2.200(55.88)
10	CH2542A-10	0.900(22.86)	1.000(25.40)	23	CH2542A-23	2.200(55.88)	2.300(58.42)
11	CH2542A-11	1.000(25.40)	1.100(27.94)	24	CH2542A-24	2.300(58.42)	2.400(60.96)
12	CH2542A-12	1.100(27.94)	1.200(30.48)	25	CH2542A-25	2.400(60.96)	2.500(63.50)
13	CH2542A-13	1.200(30.48)	1.300(33.02)	30	CH2542A-30	2.900(73.66)	3.000(76.20)
14	CH2542A-14	1.300(33.02)	1.400(35.54)	40	CH2542A-40	3.900(99.06)	4.000(101.60)

.100"(2.54mm) pitch FFC/FPC crimp terminal

P/N: CT2542T, CT2542AT

Crimp Female Terminal

Designed for flat flexible cable assembly

Mates 0.64mm square pin.

Material: Phosphor Bronze

Finished: Tin Plated

Used in series housing: CH2542A, CH2542B

HF2543A, HF2545A

CT2542T for 2P~12P, CT2542AT for 13P~40P

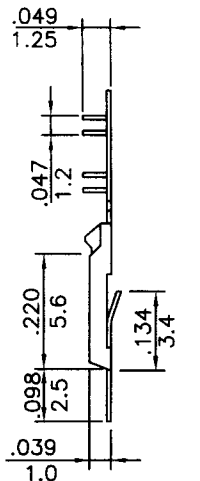
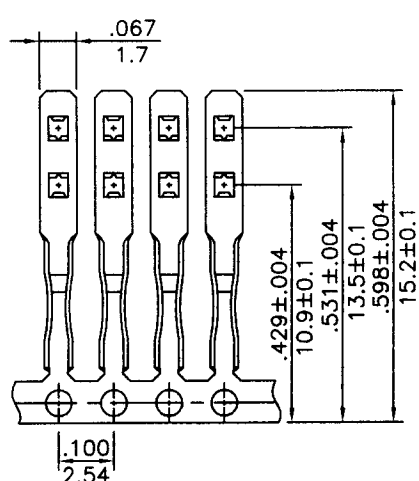

P/N: CT2542BT

Crimp Dip Terminal

Designed for flat flexible cable assembly

Suitable for flexible P.C.B.

Material: phosphor bronze

Finished: Tin Plated

Reel Q'ty: 30,000 pcs

