

REV	ECN. NO.	APPD.
A	DC14048	T.K MENG 8/7/2004

NOTES:
 1. OPERATION TEMPERATURE : -40°C -105°C
 2. DIMENSIONING SHALL BE INTERPRETED PER ANSI Y14.5M-1994
 3. CONTACT RETENTION FORCE: 1.36 Kgf MIN.

△ PROD. NO. P300 -NN- N-NN

CODE:
 NONE: NO PEG
 G1: WITH PEG #1
 G2: PEG #1&PEG #2
 CONTACT AREA PLATING
 0=100u" MIN. TIN PLATING OVER ALL
 2=GOLD FALSH OVER ALL
 8=15u" GOLD OVER CONTACT AREA
 NO.OF POS.

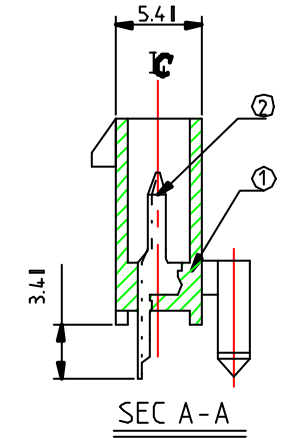
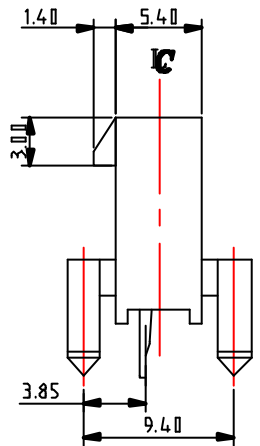
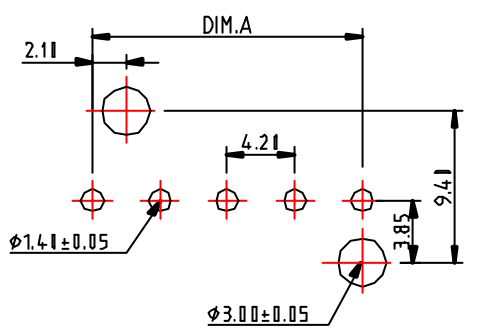
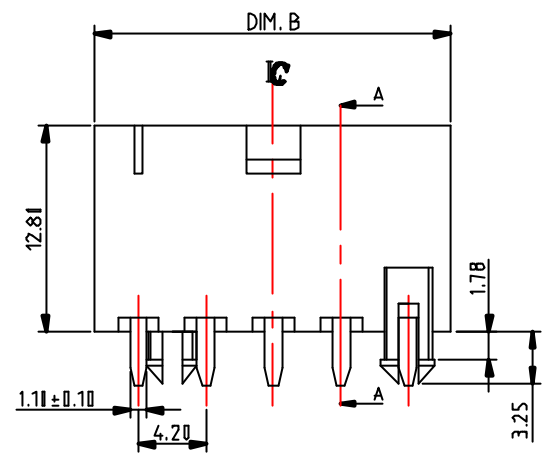
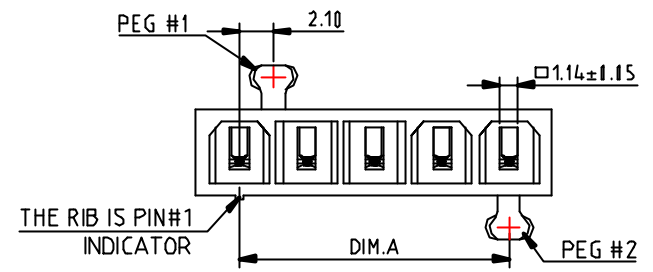

ITEM	Q'TY	DESCRIPTION
①	1	HOUSING, PA66 UL94V-1, IVDRY COLOR
②	BASE OF POS.	CONTACT, BRASS, 51u" MIN NICKEL UNDER PLATED

COMPONENT PARTS LIST

X.±	.X± 1.38	.XX± 1.25	NAME-INTENDED USE->	CTL CHARTRON INCORPORATION
X°±	.X°±	.XX°±	POWER CONN.	
UNITS:	mm	DATE: 8/1/2004	PART NO.-INTENDED USE->	TITLE:
MAT'L			P300 SERIES	CUSTOMER DRAWING
			APPD: T.K MENG	DWG NO.
			CHKD: GUOCHAO YAN	010-0102-433
			DR: LIU XIAO YE	SCALE SHEET REV
				N/A 1/1 A

P311-02-x-xx	2	4.20	9.60
P311-03-x-xx	3	8.40	13.80
P311-04-x-xx	4	12.60	18.00
P311-05-x-xx	5	16.80	22.20
PART NO.	NO.OF POS.	DIM.A	DIM.B