

# SMD POWER INDUCTORS ANB-HC TYPE

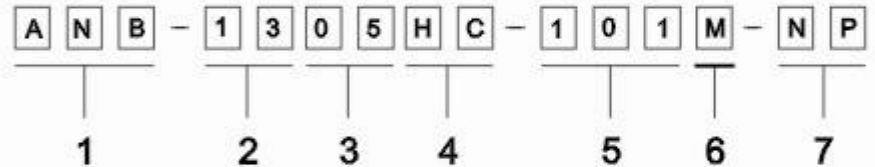

## PRODUCT IDENTIFICATION



1. PRODUCT SYMBOL
2. OUTSIDE DIA : mm
3. BODY HEIGHT : mm
4. TERMINAL BY WIRE
5. INDUCTANCE :  $\mu\text{H}$
6. TOLERANCE : K $\pm$ 10% , L $\pm$ 15% , M $\pm$ 20%
7. Meet ROHS Regulations of Prohibited 6 Poisonous Materials

## SHAPES & DIMENSION FOR ANB HC SERIES (mm)

### FEATURE

- Maximum power density.
- Modified standard products are available.
- Miniature surface mount design.
- High current low voltage applications.

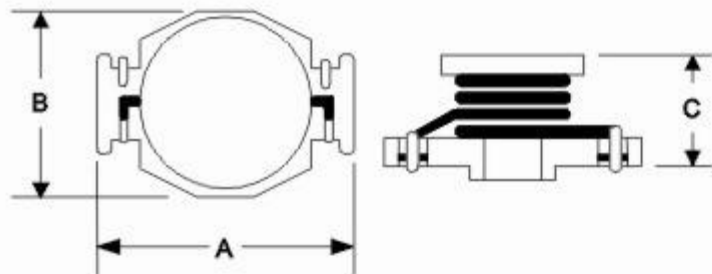

### RECOMMENDED PATTERN (mm)

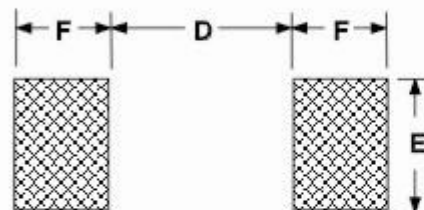

TYPE	A	B	C	D	E	F
ANB 1305C-HC	13.50Max.	9.91Max.	6.35Max.	10.16	4.06	1.52
ANB 2207-HC	22.35Max.	16.26Max.	8.50Max.	17.53	8.64	3.18



# SMD POWER INDUCTORS ANB-HC TYPE

## ELECTRICAL SPECIFICATION

Part NO.	Inductance L( $\mu$ H)	RDC( $\Omega$ )Max.		Rated DC Current(A)Max.	
		1305 HC	2207 HC	1305 HC	2207HC
R33	0.33	0.002		16.00	
R68	0.68	0.005		12.00	
1R0	1.0	0.006	0.011	10.00	20.00
1R5	1.5	0.008		9.00	
2R2	2.2	0.011	0.014	7.40	16.00
2R7	2.7	0.012		6.60	
3R3	3.3	0.014	0.016	5.90	14.00
4R7	4.7	0.018		4.80	
5R6	5.6		0.022		12.00
6R8	6.8	0.023		4.50	
100	10	0.0299	0.032	4.30	10.00
150	15	0.0449	0.036	3.60	8.00
220	22	0.0644	0.047	2.90	7.00
330	33	0.0989	0.066	2.40	5.50
470	47	0.1461	0.087	1.90	4.50
680	68	0.1898	0.130	1.70	3.50
101	100	0.2772	0.019	1.40	3.00
151	150	0.4244	0.250	1.10	2.60
221	220	0.6360	0.380	0.93	2.40
331	330	0.9775	0.560	0.76	1.90
471	470		0.850		1.40
681	680		1.200		1.20
102	1000		1.800		1.00
122	1200				

Operating Temperature : -40°C~ +85 °C  
 Test Freq. : 100KHz/0.1V  
 Inductance drop  $\leq$  10% Typ. At IDC