

RoHS Compliant

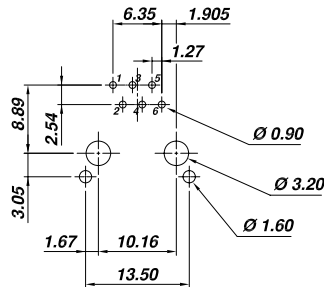
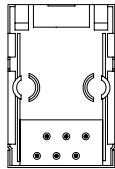
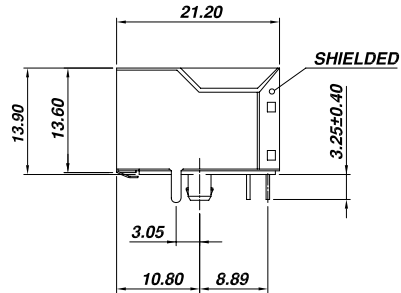
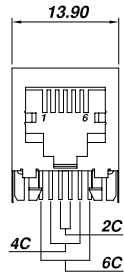

PCB LAYOUT  
(Top View)

**SPECIFICATION :**

**1. Electrical Char.**

Insulation Resistance : 500M-Ohm Min. 500V DC. for 1 minute.  
 Contact Resistance : 30milli-Ohm Max.  
 Rating Current : 1.5A Max.  
 Rating Voltage : 150V AC.  
 Dielectric Voltage : 1,000 Vrms at 1MA 60 Sec. Min.

**2. Physical char.**

Housing (Option) : For Waving Soldering Process  
 PBT Glass Filled (UL 94V-0),Soldering Temperature:235°C for 5 Sec.  
 Nylon (UL 94V-0),Soldering Temperature:260°C for 5 Sec.  
 Color : Black Color  
 Spring Wire :  
 0.45mm Dia. Phosphor bronze Gold Plating Over Nickel.  
 Shielded : Brass Plating Nickel  
 Temperature Range : - 40°C / +85°C  
 Durability : 750 Mating cycles Min.

**AJ-007SH-6-X-XX-A1-N1**

B=6p2c, C=6p4c  
D=6p6c

L=PBT Glass Filled  
R=Nylon

Gold plated  
1=15u , 4= 6 u  
2=30u , 5= 2-3u  
3=50u , 6= Flash

**ALLSUN CORPORATION**

9FL,NO.292 SEC.7 CHENG TEH ROAD.TAIPEI TAIWAN.  
E - mail Address : allsun @ globalsources . com

**TITLE**

**RJ11 or RJ12 SIDE ENTRY SHIELDED PCB JACK  
UL & cUL FILE NO. E131820**

**MODULAR JACKS ASSY FOR  
AJ-007SH-6-X-XX-A1-N1**

**SCALE SIZE DWG. NO. 9636S SERIES**

NOT SCALED DRAWING	TOLERANCE UNLESS OTHERWISE NOTICE	INCH	MM	DR.	DATE
 THIRD ANGLE PROJECTION	LINEAR $\frac{MM}{INCH}$	.00±0.01	.00±0.25	Steven	MAY-31 '13
		.000±0.005	.000±0.13	CK'D Johnn	MAY-31 '13
$\frac{MM}{INCH}$	ANGLE +0° 30'	RADII	+0.45 -0.15	APP'D Billy	MAY-31 '13

DWG. NO.

AST007A05-1